

**DEPARTMENT OF EMERGENCY MEDICAL SERVICE
BID # 25-05-3689LE**

REQUEST FOR PROPOSALS

PROPOSAL DUE DATE : 15 JULY 2025

DESCRIPTION : FIFTEEN (15) TYPE I AMBULANCES

CONTACT PERSON : Penny Hoskie-Johnson, Field Operations Officer East
Office of Field Operations
DEPARTMENT OF EMERGENCY MEDICAL SERVICE
DIVISION OF PUBLIC SAFETY
TELEPHONE NO. (505) 696-5459
EMAIL: pmhoskie-johnson@navajo-nsn.gov

RETURN ALL RESPONSES TO

DELIVER TO : THE NAVAJO NATION
PURCHASING SERVICES DEPARTMENT
1st Floor, Administration Building #1
WINDOW ROCK, ARIZONA 86515
ATTN: Ms. Lorita Etsitty
TELEPHONE NO. (928) 871-6317
*NOTE: THE BID NUMBER AND THE VENDOR MUST BE INDICATED
ON THE OUTSIDE OF THE PACKAGE.

MAIL TO : THE NAVAJO NATION
PURCHASING SERVICE DEPARTMENT
POST OFFICE BOX 9000
WINDOW ROCK, ARIZONA 86515
ATTN: Ms. Lorita Etsitty
TELEPHONE NO. (928) 871-6317
*NOTE: THE BID NUMBER AND THE VENDOR MUST BE INDICATED
ON THE OUTSIDE OF THE PACKAGE.

SECTION I

INFORMATION ONLY NO RESPONSE TO THIS SECTION IS REQUIRED

- A. ISSUING OFFICE:** This request for Proposals (RFP) is issued by the Purchasing Services Department of the Navajo Nation, P.O. Box 3150, Window Rock, Arizona 86515
- B. PURPOSE:** This RFP provides prospective respondents with sufficient information to enable them to prepare and submit proposals for consideration.
- C. SCOPE:** This RFP contains the instructions governing the proposals to be submitted and material to be included therein; mandatory requirements which must be met to be eligible for consideration; and other requirements to be met by each proposal.
- D. NAVAJO BUSINESS OPPORTUNITY ACT:**

1. Bidder is to visible mark on the outside of the proposal package, if applicable, the offeror's priority status under the Navajo Nation Business Opportunity Act.
2. The Navajo Nation is not bound to enter a contract under the RFP or RSQ and may issue a subsequent RFP or RSQ for the same services.
3. The Navajo Nation is a sovereign government and that all contracts entered into as a result of the RFP shall comply with Navajo Nation law, rules and regulations, including the Navajo Preference in Employment Act.

E. SCHEDULE OF ACTIVITIES:

DEADLINE:

- | | |
|--|----------------------------|
| 1. Public Advertisement | 18- 26 June 2025 |
| 2. Prospective respondents inquire deadline
(No questions accepted after this date) Inquiries and questions will be answered at any time prior to this date. Questions to this RFP may be verbal or in writing. | 30 June @ 5:00 pm DST |
| 3. Due date for proposal | 03 July 2025 @ 5:00 pm DST |
| 4. Opening of proposals and evaluation | 08 July 2025 |
| 5. Award date for contract | 14 July 2025 |
- F. INQUIRIES:** Prospective respondents may make telephone or written inquiries concerning this RFP to obtain clarification of requirements. No inquiries will be accepted after the inquiry deadline listed in Section D. Mailed inquiries are to be addressed to:

**THE NAVAJO NATION
PURCHASING SERVICES DEPARTMENT
POST OFFICE BOX 9000
WINDOW ROCK, ARIZONA 86515
ATTN: Ms. Lorita Etsitty**

TELEPHONE (928) 871-6316

Note: Please mark on the outside of the envelope or subject line of email – EMS Ambulance Inquiry.

- G. ADDENDUM OF SUPPLEMENT TO THIS REQUEST FOR PROPOSALS:** In the event that Navajo Nation Emergency Medical Service finds it becomes necessary to revise any part of this RFP, an addendum will be issued.
- H. PROPOSALS SUBMISSION:** Bidders who are mailing their proposals should allow sufficient time for mail delivery to ensure receipt by the time specified. It is recommended they be sent by certified mail to the address indicated on the cover sheet of this RFP.
- I. TWO (2) COPIES OF PROPOSALS ARE REQUIRED:** (including the original) and should be delivered in a sealed envelope; also include the name and address of the individual or firm submitting the proposal.
- J. LATE RECEIPT OF PROPOSALS:** Late proposals will not be accepted. It is the responsibility of the bidder to ensure the proposal arrives in the Purchasing Services department prior to the date and time specified.
- K. REJECTION OF PROPOSALS:** The Purchasing Services Department reserves the right to reject any or all proposals and to waive informalities and minor irregularities in proposals received.
- L. PROPRIETARY INFORMATION:** Any restriction on the use of data contained within any proposals must be clearly stated in the proposal itself. Proprietary information submitted in response to this RFP will be handled in accordance with applicable purchasing procedures. Each and every page of the proprietary material **must be** labeled or identified with the word "proprietary".
- M. RESPONSE MATERIAL OWNERSHIP:** All material submitted regarding this RFP shall become the property of the Navajo Nation and will not be returned to the bidder. Responses received will be retained in file and may be reviewed by any person after final selection has been made, subject to Paragraph K above. The Purchasing Services Department has the right to use any or all system ideas presented in reply to this RFP, subject to limitations outlined in paragraph K above. Disqualification or non-selection of a bidder or bid does not eliminate this right.
- N. INCURRING COSTS:** The Navajo Nation Purchasing Service Department is not liable for any cost incurred by the bidders prior to issuance of an agreement, contract and/or purchase order.
- O. ACCEPTANCE OF PROPOSAL CONTENT:** The contents of the proposal of the successful bidder will become contractual obligations if acquisition action ensues. Failure of the successful bidder to accept these obligations in a purchase agreement, purchase order, delivery order or similar acquisition instrument may result in cancellation of the award and such bidder may be removed from future solicitations. The Navajo Nation Purchasing Services Department reserves the right to pursue appropriate legal action in the above set of circumstances.
- P. EVALUATION PROCEDURES AND CRITERIA:**
1. General Procedures:
 - a. An ad hoc committee will judge the merit proposals received in accordance with the criteria defined herein.
 - b. Failure of a bidder to provide any information requested in this RFP may result in disqualification of the proposal. All proposals must be endorsed with the signature of a responsible official having the authority to bind the offeror or to the execution of the proposal.

- c. The sole objective of the ad hoc committee will be to select the bidder whose proposal is most responsive to the Navajo Nation Purchasing Services Department. The specifications within this RFP represent the minimum performance necessary for response. On the basis of the evaluation criteria established in this RFP, the ad hoc committee will select and recommend the bidder who best meets this objective.
- d. Evaluation Criteria: The following criteria will be used by the ad hoc committee in the selecting process for contract award. The technical proposal factors will be rated on a scale of 10-100 with weight relations as stated below:

<u>Technical Proposal Factors:</u>	<u>Total Points: 100</u>
<u>Quality, Accuracy, and Completeness of the proposal</u>	20
<u>Manufacturing and Delivery schedule</u>	15
<u>Primary manufacturer's demonstrated capabilities and qualifications</u> Offeror's qualifications, including work on similar projects, experience of personnel, how long firm has been producing ambulances.	10
<u>Primary manufacturer's past performance on similar Bid Proposals</u>	10
<u>Primary manufacturer's maintainability and recommendations</u>	10
<u>Primary manufacturers logistical and service support</u>	10
<u>Cost-Price offered is responsive to the RFP requirements and Instructions, and is realistic in respect to specifications and requirements</u>	25

- Q. STANDARD CONTRACT:** The Navajo Nation reserves the right to incorporate standard contract provision into any contract negotiations as a result of a proposal submitted in response to this RFP.
- R. RETURN OF PROPOSALS:** The Navajo Nation has no obligation to return any proposal received in response to this RFP.
- S. GOVERNING LAW:** This procurement and any agreement with offerors that may result shall be governed by the laws of the Navajo Nation. Navajo Business Opportunity Act, 5 NNC will apply.
- T. ALTERNATE PROPOSALS:** Alternate proposals will not be accepted and will be deemed non-responsive.

SECTION II

PROPOSAL FORMAT AND ORGANIZATION

A. NUMBER OF COPIES

Proposer shall provide two (2) identical copies of the proposal to the location specified for the submission of proposals in Section I, Paragraph H, on or before the closing date and time for receipt of proposal.

B. PROPOSAL FORMAT

All proposals must be typewritten on standard 8.5 x 11 paper (larger paper is permissible for charts, spreadsheets, etc.) and placed within a binder with tabs delineating each section, as necessary.

1. Proposal Organization

The proposal must be organized and indexed in the following format and must contain as minimum all list items in the sequence indicated.

- a. Table of Contents
- b. Letter of Transmittal
- c. Cost Proposal
- d. Response to the Specifications request
- e. Exceptions & Clarifications
- f. Drawings
- g. Warranties
- h. Professional References
- i. Copy of certifications, licenses, insurance, testing (i.e., manufacturer, ISO, Business).
- j. Credentials (W-9, Insurance)
- k. Appendix (if needed)

Any proposal that does not adhere to these requirements may be deemed non-responsive and rejected on that basis.

Proposer may attach other materials which they feel may improve the quality of their response. However, the material should be included as items in the appendix.

2. Letter of Transmittal

Each proposal must be accompanied by a letter of transmittal. The letter of transmittal must:

- a. Identify the submitting organization with a brief description;
- b. Identify experience, capability and capacity
- c. Identify the name and title of the person authorized to contractually obligate the organization;
- d. Identify the name, title and telephone number of the person authorized to negotiate the contract on behalf of the organization;
- e. Identify the name, title and telephone numbers of person to be contacted for clarification;
- f. Be signed by the person authorized to contractually obligate the organization; and
- g. Acknowledge receipt of any and all amendments to the RFP.

C. SCOPE, PURPOSE AND CLASSIFICATION:

1.0 SCOPE

This specification covers a new commercially produced surface emergency medical care vehicle(s), herein referred to as an "ambulance" or "vehicle". This vehicle shall be in accordance with the Ambulance Design Criteria of the National Highway Traffic Safety Administration, United States Department of Transportation, Washington DC. This specification is based on current approved Federal Ambulance Specification KKK-A-1822-F guideline requirements inclusive of all GSA change notice requirements. It is the intent of Navajo Nation Emergency Medical Service to purchase vehicle(s) that are professionally engineered and designed. The ambulance described herein shall be type and model tested to and in compliance with the National Truck Equipment Association's Ambulance Manufacturing Division, Standards 001 – 028

and all currently required SAE test requirements. Certifications must be current to manufacturer's most recent manufacturing/engineering design criteria. It is paramount to Navajo Nation Emergency Medical Service that vehicle(s) presented be built by a reputable manufacturer with considerable experience in the ambulance manufacturing field. To this end, Navajo Nation Emergency Medical Service requires that each manufacturer provide the following:

1. The size and location of manufacturing facilities and number of production staff.
2. Interior pictures to verify plant facilities.
3. The primary manufacturer shall submit proof that it is a 'member in good standing' with the Ambulance Manufacturers Division (AMD) of the National Truck Equipment Association (NTEA).

Failure to provide Navajo Nation Emergency Medical Service with the documentation required will be deemed non-responsive.

The standard for the configuration and design of this ambulance exceeds the current KKK Federal Specification due to the requirements of this department. Manufacturers who are unwilling or unable to meet the requirements herein will not be considered.

COMPLY: YES_____ NO_____

1.1 PURPOSE

The purpose of this document is to provide the manufacturer with a set of specifications and test parameters that will meet the criteria to manufacture a vehicle as set forth by Navajo Nation Emergency Medical Service. Navajo Nation Emergency Medical Service seeks a vehicle that will deliver "fair value". Fair value is defined by Navajo Nation Emergency Medical Service as the manufacturer's ability to provide a safe, functional, and practical ambulance conversion that will work in junction with the chassis specified at a reasonable cost. The specifications within this document are a basis to deliver such a vehicle to Navajo Nation Emergency Medical Service.

This specification requires an all-aluminum modular exterior and interior wall structure. The compartment and cabinet sizes are critical, and changes will not be allowed. While it is not the intent of this specification to preclude any qualified bidder, it must be clear that any bidder deviating in any substantial manner from these specifications will be rejected as non-compliant.

It should be noted, however, that this specification is written around specific needs of this agency. With the intent to standardize certain components, therefore, in numerous places we have named specific brands of components. This has been done to establish a certain standard of quality. Other brands may be accepted providing the vendor provides documentation in the bid that the brand offered meets or exceeds the quality of the actual brand called for in the specification.

Navajo Nation Emergency Medical Service at its discretion shall assess the intangible assets of the manufacturer such as, but not limited to, after quality, delivery support, customer service, parts availability and warranty turn-around time.

1.2 GENERAL

This is an engineer, design, construct and deliver type specification meeting the needs of Navajo Nation Emergency Medical Service. Attention has been given to the engineering and design aspect of this specification that will attain our goal of fair value. It is the manufacturer's responsibility to deliver a product meeting the criteria as set forth. Navajo Nation Emergency Medical Service reserves the right to increase the equipment quantities that are specified.

1.3 SITES OF WORK:

Other than the chassis, specified accessories, and raw materials such as aluminum, wood, etc.; all shops and sub-shops shall be within the complex(s) that are directly owned and controlled by the primary manufacturer. Any assemblies

including, but not limited to, upholstery, fiberglass, cabinetry, electrical, structural and paint application, that are performed or supplied outside of the primary manufacturer's location(s) must be noted. The name, address, and contact person supplying the primary manufacturer with the assemblies must be provided in writing to Navajo Nation Emergency Medical Service. Non-disclosure will be sufficient grounds for rejection of bid or termination of contract. Ambulances or chassis' imported for consideration of this specification into the United States under the North America Free Trade Act must provide documentation of compliance with all United States laws applicable. Further, any import ambulance must be independently certified and tested within the United States to meet the Federal Ambulance Specification KKK-A-1822-F certification guidelines.

COMPLY: YES ____ NO ____

1.4 EXAMINATION OF SPECIFICATIONS

It is incumbent on each manufacturer to be thoroughly familiar with the specification contained herein. The specification will require a "YES" or "NO" or when requested a definitive answer to each section or subsection. Sections or subsections not marked with a "YES" or "NO" or answered shall be deemed incomplete and considered non-responsive. A "YES" answer constitutes a complete compliance to the section or subsection as written. A "NO" shall indicate noncompliance and does not eliminate a manufacturer from competition.

A manufacturer may object or counter to a specific section or subsection. A manufacturer must indicate in writing, as an attachment, the section or subsection in dispute. The manufacturer must include the verbiage as written, new verbiage presented, explanation of verbiage with consequences and supporting tests and documentation. Failure to comply will be deemed as non-responsive. Navajo Nation Emergency Medical Service reserves the right to determine compliance.

1.5 DEFINITIONS

The following definitions shall apply with regards to these specifications.

1.5.1 PURCHASER

The end user of the equipment specified or the applicable purchasing agency acting on behalf of the end user.

1.5.2 CONTRACTOR

The individual, firm, partnership manufacturer, or corporation to whom the contract is awarded by Navajo Nation Emergency Medical Service and is subject to the terms thereof. For bidding purposes, the contractor, vendor, bidder, manufacturer are synonymous.

1.5.3 EQUAL

Navajo Nation Emergency Medical Service supports the design, engineering, quality and materials as specified in this document. This shall not prohibit the bidding of unlike product. However, any deviation from the specification must be marked and submitted per section 1.1.2. Failure to do so shall be deemed non-responsive.

1.5.4 MANUFACTURER

The manufacturer within this specification shall be considered the "primary manufacturer" of the ambulance conversion. The chassis requirement as set forth in this specification is the responsibility of the primary manufacturer to procure. Navajo Nation Emergency Medical Service considers the chassis platform as a conveyance for the ambulance conversion. It is imperative that the primary manufacturers procure the exact chassis from the chassis manufacturer. After market modifications by the primary manufacturer to achieve chassis specification will not be tolerated. Navajo Nation Emergency Medical Service will require documentation from the chassis manufacturer pertaining to the chassis requirements for Navajo Nation Emergency Medical Service. Failure to provide documentation after award and prior to construction may result in the termination of the contract.

Expenses to re-bid will be the responsibility of the manufacturer in default.

2.0 SPECIAL CONDITIONS:

2.1 BIDDERS RESPONSIBILITY AND QUALIFICATION:

2.1.1

It is not the intent of these specifications to call for an unusual or experimental vehicle(s). The primary manufacturer shall have a minimum of 10 years of uninterrupted manufacturing of similar or identical vehicles to the specifications set forth in this bid.

COMPLY: YES___ NO___

2.1.2

The primary manufacturer must submit a list of ten (10) agencies/customers that have purchased similar or identical vehicles within the past two (2) years from date of bid. The list will have contact names, addresses and phone numbers. The ten references must be enclosed with the bid package.

COMPLY: YES___ NO___

2.1.3

The primary manufacturer shall be ISO 9001:2008 certified. **No Exceptions.**

COMPLY: YES___ NO___

2.1.4

The primary manufacturer shall employ full time, a Quality Control Manager whose primary function is to monitor quality. **No Exceptions.**

COMPLY: YES___ NO___

2.2 PAYMENT, DELIVERY AND ACCEPTANCE:

2.2.1

After selection of vendor, the attached professional service contract will be the governing terms and conditions for the service and goods.

COMPLY: YES___ NO___

2.2.2

All bid prices and conditions must be specified on the Bid Proposal Form.

COMPLY: YES___ NO___

2.2.3

Bid prices shall be valid for ninety (90) days. In the unforeseen circumstance that Navajo Nation Emergency Medical Service requires the primary manufacturer to extend pricing requirement; then it will be at the discretion of Navajo Nation Emergency Medical Service to request in writing from the primary manufacturer any deviation in prices quoted. The primary manufacturer may revise pricing and state in writing reasons for any change and certify the amended pricing for ninety (90) additional days.

COMPLY: YES___ NO___

2.2.4

Bid proposals taking total exception to these specifications will not be accepted.

COMPLY: YES___ NO___

2.2.5

Bid proposals that do not comply with the prescribed method to take exceptions listed in paragraph 1.1.2 will be rejected without further consideration.

COMPLY: YES___ NO___

2.2.6

Navajo Nation Emergency Medical Service seeks the highest level of value for the cost.

To assure Navajo Nation Emergency Medical Service is receiving such value the primary manufacturer must submit evidence of compliance with the Federal Ambulance Specification KKK-A-1822-F testing parameters. The testing is to be performed by an independent testing facility and verified by person(s) with the standing of Professional Engineer. If further testing is required by any lawful agency of the Federal or State Government then it shall be incumbent upon the primary manufacturer to provide Navajo Nation Emergency Medical Service with certification required.

COMPLY: YES___ NO___

2.2.7

Navajo Nation Emergency Medical Service also recognizes Ford Motor Company's Qualified Vehicle Modifiers (QVM) accreditation. Therefore, regardless of chassis specifications the primary manufacturer must include with this proposal their current QVM certification.

COMPLY: YES___ NO___

2.2.8

Internal testing performed and certified for a primary manufacturer will not be considered by Navajo Nation Emergency Medical Service.

COMPLY: YES___ NO___

2.2.9

The primary manufacturer may submit certification of all "member in good standing" of any public or private association that may have bearing on this specification i.e. NTEA.

COMPLY: YES___ NO___

2.3 CONTRACT AWARD:

Navajo Nation Emergency Medical Service reserves the right to increase the number of vehicles or equipment specified under this contract. If awarded, the primary manufacturer agrees that additional agencies may purchase under the same terms and prices afforded by any contract arising from the bid award, unless prohibited by law.

COMPLY: YES___ NO___

2.4 WARRANTY:

Navajo Nation Emergency Medical Service is concerned with the ability of the primary manufacturer to warrant the conversion after delivery.

Navajo Nation Emergency Medical Service expects a lifetime modular construction warranty and twenty-four (24) months and thirty thousand (30,000) miles full warranty on the conversion. In addition, each manufacturer shall submit their various warranties and warranty options, if applicable, with the proposal for evaluation. Also, each primary manufacturer will supply the name and phone number of a contact person in the event Navajo Nation Emergency Medical Service requires clarification of the submitted warranty documents. The primary manufacturer will provide the location of the closest approved warranty center. Indicate to Navajo Nation Emergency Medical Service, in writing, to be included with this proposal; the process to initiate and file a warranty claim.

COMPLY: YES___ NO___

2.4.1 TECHNICAL ASSISTANCE AVAILABILITY

Due to the high demands on a pre-hospital care vehicle, Navajo Nation Emergency Medical Service demands the primary manufacturer have available a twenty-four hour a day technical assist service. This 24/7 service must be staffed by the primary manufacturer's service personnel.

COMPLY: YES___ NO___

2.5 DELIVERY:

The primary manufacturer will provide in writing to accompany this document a proposed delivery time. The delivery time proposal will include the transit time of the finished vehicle.

COMPLY: YES___ NO___

2.6 INSURANCE.

The Navajo Nation requires the following minimum insurance requirements:

2.6.1 Commercial General Liability

Coverage, ISO CG 0001 Form or equivalent with minimum limits of One Million United States Dollars (\$1,000,000.00 USD) per occurrence, Two Million United States Dollars (\$2,000,000.00 USD) aggregate.

COMPLY: YES___ NO___

2.6.2 Auto Liability

Minimum limit of One Million United States Dollars (\$1,000,000.00 USD) per accident and should include non-owned autos.

COMPLY: YES___ NO___

2.6.3

The Navajo Nation shall be named as additional insured for general and auto liability coverages only.

COMPLY: YES___ NO___

2.6.4 Garage Keepers Liability

With limits no less than One Million United States Dollars (\$1,000,000.00 USD) per claim. This coverage should be on a claims made basis and the retro date should be no later than the start date of the project/agreement.

COMPLY: YES___ NO___

2.6.5 Waiver of Subrogation

All coverages should include a waiver of subrogation.

COMPLY: YES___ NO___

2.6.6 Coverages

All coverages should be primary and the Navajo Nation's coverage non-contributory.

COMPLY: YES___ NO___

2.7 FAMILIARITY WITH LAWS:

The primary manufacturer will be familiar with all Federal, State and Local laws, ordinance, code rules and regulations that may in any way effect the work. Ignorance on the part of the primary manufacturer is not acceptable.

COMPLY: YES___ NO___

2.8 PRE-CONSTRUCTION AND FINAL INSPECTION CONFERENCE:

The successful primary manufacturer shall be required to hold a pre-construction and final inspection conference with representatives of Navajo Nation Emergency Medical Service at the manufacturing facility. The primary manufacturer will be responsible to provide airfare, transportation from airport to plant and return, lodging, and meals for two (2) designated personnel from Navajo Nation Emergency Medical Service. Further, if the location is in an excess of three hundred (300) miles from this agency's location, the transportation shall be by a commercial air carrier. Private or corporate aircraft may not be used. If the bidder is not in the full-time employment of the company who will manufacture the vehicle, they will be required to attend both of these meetings.

COMPLY: YES___ NO___

2.9 DRAWINGS:

The primary manufacturer shall provide a set of drawings that accurately depicts the vehicle as specified. The drawings will show all exterior and interior planes with dimensions. Failure to comply will be deemed non-responsive.

COMPLY: YES___ NO___

2.10 ANTI-COLLUSION STATEMENT:

By signing this bid, the primary manufacturer agrees that this bid is made without any understanding, agreement or connection with any other person, firm or corporation making a bid for the same purpose and this bid is in all respects fair and without collusion or fraud.

COMPLY: YES___ NO___

SECTION III **SPECIFICATIONS**

2.0 CHASSIS

2.1 **TYPE I AMBULANCE:** The apparatus shall be a Type I, 4x4, 2-door, current year model Ford F-450 x 169" WB cab/chassis with a transferable, modular ambulance body. Chassis color will be Carbonized Gray Metallic,

COMPLY: YES ___ NO ___

2.2 **AMBULANCE PREPARATON PACKAGE:** The chassis provided shall be equipped with a 47A ambulance preparation package designed and installed by the chassis O.E.M. The package shall be designed to meet the demands and duty cycles inherent in Emergency Medical Vehicles.

COMPLY: YES ___ NO ___

2.3 **THROTTLE – HIGH IDLE:** An O.E.M. throttle control shall be provided. The throttle shall be programmed for charge protect. The throttle control module shall be set to engage when the unit is placed in park with the emergency brake set.

COMPLY: YES ___ NO ___

2.4 **GROSS VEHICLE WEIGHT RATING (GVWR):** The GVWR of the chassis supplied shall be at least 16,500 pounds.

COMPLY: YES ___ NO ___

2.5 **FRONT AXLE WEIGHT RATING (GAWR):** The GAWR shall be rated at no less than 6,500 (4x4).

COMPLY: YES ___ NO ___

2.6 **REAR AXLE WEIGHT RATING (GAWR-R):** F-450: The GAWR-R shall be rated at no less than 12,880 pounds.

COMPLY: YES ___ NO ___

2.6.1 **REAR SUSPENSION:** The chassis shall be equipped with a Liquid Spring (F-450) DS137FS3 suspension. The system shall be designed to automatically dump when the streetside rear door is opened and shall automatically raise when the door is closed. An "aid dump override" switch shall be installed on the curbside rear wall at the rear doors.

COMPLY: YES ___ NO ___

2.7 **REAR AXLE TYPE AND RATIO:** The axle type shall be limited slip differential with a 4.10:1 gear ratio.

COMPLY: YES ___ NO ___

2.8 **ENGINE:** A 6.7L PowerStroke®, diesel engine with 425HP@2800rpm and 925ft.-lb. torque@1800rpm with a minimum displacement of 6.7 liters shall be provided. The engine performance shall comply with or exceed KKK-A-1822F and AMD Standards 005- 12-Volt DC Electrical System Test, 014- Engine Cooling System Test, 017- Road Test and 022- Cold Engine Start Test.

COMPLY: YES ___ NO ___

2.9 **TRANSMISSION:** A 10-speed TorqShift® Overdrive, electronic automatic transmission with overdrive shall be provided.

COMPLY: YES ___ NO ___

2.10 **BATTERIES/ALTERNATOR:** Unless otherwise requested, two batteries shall be mounted to provide easy access for servicing. The batteries shall be at least 750 CCA each and will be located (2) under the hood. The chassis shall include dual alternators with a combined rating of 397amps.

COMPLY: YES ___ NO ___

2.11 **BRAKES:** 4-wheel anti-lock, power assisted hydraulic brakes shall be supplied by the O.E.M. The brakes shall be 4-wheel Disc type. The parking brake shall be an independent mechanical brake, provided by the O.E.M.

COMPLY: YES ___ NO ___

2.12 **TIRES:** All tires shall be identical make, tread type, size and load range. For aforementioned GVWR the tires shall be LT225/70R19.5G. A label with the recommended tire pressure shall be located on the driver's door "B" pillar, unless specified otherwise by the purchaser.

COMPLY: YES ___ NO ___

2.13 **WHEELS, POWDER COATED:** Wheels along with the spare tire shall be powder coated to match the chassis color.

COMPLY: YES ___ NO ___

2.14 **MUD FLAPS:** Heavy duty rubber Mud Flaps shall be provided behind the rear dual wheels.

COMPLY: YES ___ NO ___

2.15 **SPARE TIRE:** One (1) spare tire and wheel assembly matching the size and rating mounted wheels and tires shall be supplied and mounted in compartment #3.

COMPLY: YES ___ NO ___

2.16 **OCCUPANT RESTRAINT SYSTEM:** The front, forward facing cab seats shall be equipped with O.E.M. installed Type II lap and shoulder belt assemblies.

The seat belts shall have pre-tensioners built into the seatbelt assembly to take up belt slack during a frontal collision. The seat belt assemblies shall meet or exceed F.M.V.S.S. 208 and 209. Any transition trim panels installed in the cab shall not interfere with the swivel arc of the shoulder rings.

COMPLY: YES ___ NO ___

2.17 **SUPPLEMENTAL RESTRAINT SYSTEM:** An O.E.M. air bag shall be installed on the driver and passenger side. Permanent or quick release ambulance conversion components shall not interfere with air bag deployment. The air bags must be completely operational. Modifications by the secondary manufacturer are not acceptable.

COMPLY: YES ___ NO ___

2.18 **FUEL TANK:** The fuel capacity shall be at least 40 U.S. gallons. The fuel range shall be at least 250 miles per KKK-A-1822F 3.4.8.

COMPLY: YES ___ NO ___

2.19 **CAB SEATS:** Included in the 18C interior upgrade package shall be O.E.M. High back, stain-resistant cloth covered bucket type seats shall be provided in the cab. The seats shall adjust forward and aft. Seat base must be O.E.M. After-market seats and/or bases are not acceptable due to certified requirements regarding S.R.S. (Air bag) deployment geometry. The seats shall be moisture repellant in case of contact with blood or body fluids.

COMPLY: YES ___ NO ___

2.20 **FORD CAB OPTION:** An O.E.M. AM/FM/CD in dash radio shall be included with the chassis. Ford option 913, SYNC 3 package with 8" LCD screen. Ford Pass Connect 4G Wi-Fi Modem.

COMPLY: YES ___ NO ___

2.21 **MIRRORS:** Dual electrically controlled power remote/heated, extending mirrors with built in convex mirror shall be provided.

COMPLY: YES ___ NO ___

2.22 **DOOR LOCKS:** The cab doors shall have O.E.M. power door locks. A momentary rocker type switch shall active (Lock/Unlock) both cab doors.

COMPLY: YES___ NO___

2.23 **TRIM PACKAGE:** The chassis shall be equipped with a complete XLT trim package supplied the Ford Motor Company. The package shall include the 18A exterior upgrade package with high quality chrome-like bright work on the grille face. Chrome plated steel bumper(s) shall also be supplied by the O.E.M. Argent or painted bumpers are not acceptable. The O.E.M. grille shall not be replaced with any aftermarket materials; it shall remain as provided by the O.E.M.

COMPLY: YES___ NO___

2.24 **RUNNING BOARDS:** Running boards shall be constructed of CNC cut and formed .125 aluminum diamond plate and provide "splash guard" components to protect the running board surfaces from front wheel wash. The running boards shall include a CNC punched starburst pattern to provide a skid resistant step surface.

COMPLY: YES___ NO___

2.25 **UNDERCOATING:** Chassis and module shall be fully undercoated in accordance with the chassis manufacturer's guidelines.

COMPLY: YES___ NO___

2.26 **WINDSHIELD SUN VISORS:** OEM, stain resistant cloth covered sun visors shall be installed over the driver's and passenger's sides of the windshield.

COMPLY: YES___ NO___

2.27 **DAYTIME RUNNING LIGHTS:** The chassis shall come equipped with OEM daytime running lights.

COMPLY: YES___ NO___

2.28 **OEM REVERSE/BACK-UP CAMERA :** Shall be removed.

COMPLY: YES___ NO___

2.29 **CAMERA SYSTEM:** ASA Electronics, (1) VCMS104i - (1) Flush Mount Camera/White, VOM74MM - 7" Rear View Mirror Color Monitor with brightness, contrast and volume adjustment controls, CEC34 - 32ft. Cable. Locate: (1) Camera mounted off lower RH corner of center rear Amber light; Monitor mounted on cab windshield rear view mirror.

COMPLY: YES___ NO___

2.30 **DOOR LOCKS:** All entry and compartment Doors shall be wired to the OEM door lock system. Switching: Power Door Locks Only, (2) door lock switches, (1) located in Positron panel, in standardized position on Curbside Wall above head of bench; (1) located in Positron switch panel, on wall at curbside rear entry door in standardized position.

COMPLY: YES___ NO___

2.31 **DOOR LOCKS:** There shall be (2) two Stealth Switch Power Door Lock Systems. One Push Button Switch in the front grille area and at the bottom corner cap on the streetside.

COMPLY: YES___ NO___

3.0 MODULE CONFIGURATION

3.1 **OVER ALL LENGTH:** The overall length of the vehicle shall not exceed two hundred ninety inches (290"). The finished vehicle shall meet or exceed KKK-A-1822F 3.4.10.4 for Angle of Departure, Ramp Break Over and Angle of Approach.

COMPLY: YES___ NO___

3.2 **MODULE LENGTH:** The module length shall be at least one hundred fifty-three (153") inches.

COMPLY: YES ___ NO ___

3.3 **MODULE WIDTH:** The module width shall comply with State requirements regarding width of vehicles permitted on its roads and highways. The module shall be ninety-four (94") inches wide, excluding lights and accessories. The rear wheels of the chassis shall not extend further than 2.5" from the vertical sidewall and be covered by fender flares as cited in Item 10.5 of this Specification.

COMPLY: YES ___ NO ___

3.4 **PATIENT COMPARTMENT HEADROOM:** The headroom within the module shall be seventy-two (72") inches. The measurement shall be taken from the center of the patient compartment floor to the ceiling panel.

COMPLY: YES ___ NO ___

3.5 **BULKHEAD CONFIGURATION:** The bulkhead wall shall be a crawl through configuration between the cab and module with a Hinged HDPE door to close off crawl-through between cab and module with 15.75" x 15.75" x .250" polycarbonate window. **NOTE: ADD A STICKER LABEL TO EACH SIDE OF DOOR STATING "KEEP DOOR CLOSED DURING OPERATION".

COMPLY: YES ___ NO ___

3.6 **COMPARTMENT CONFIGURATION:** The minimum compartment dimensions are as follows and as depicted in the CAD drawings attached to the Specification.

COMPLY: YES ___ NO ___

4.0 **MODULE CONSTRUCTION - GENERAL**

The ambulance body shall be all aluminum. The body sheet shall be reinforced with structural members designed to resist deflection and penetration and withstand conditions as per the current Federal Specification KKK-A-1822 and SAE J3057. Additionally, the modular body and structural and add on components shall be tested and in full compliance with SAE J3027, SAE J3026, SAE J2917, SAE J2956, SAE J3102. The body structure shall be manufactured by the OEM ambulance manufacturer, not an outside vendor. This Agency will not accept bids from ambulance manufacturers that sub-contract the manufacture the ambulance body being bid.

COMPLY: YES ___ NO ___

4.1 **BODY STRUCTURE ALLOY:** The side, front and rear sheets shall be derived from .125 thick 5052-H32 Aluminum sheet. The roof sheet shall be one piece .090 thick 5052-H32, from roof rail to roof rail. The side, roof and floor structure and structural shapes shall be 6005A-T61 extruded structural aluminum. The ambulance supplier represented in this bid is required to be the manufacturer of the modular body: this agency will not accept bids from ambulance manufacturers that sub-contract the ambulance body build process to an alternate supplier.

All frame and structural members shall be MIG (metal inert gas shielded) welded together to form a "roll cage" type structure. No rivets, screws, adhesive or other mechanical fasteners shall be used for the attachment of any structural or frame member used to form this critical structure.

COMPLY: YES ___ NO ___

4.2 **BODY WARRANTY:** The body shall carry a "FIFTEEN YEAR" structural warranty following the date of delivery to the end user. The warranty shall cover repairs or replacement of body elements or components that fail due to structural defects in materials and workmanship.

COMPLY: YES ___ NO ___

4.3 BODY PANEL MANUFACTURE: Each body panel, front wall, rear wall, two side walls, and roof panel, shall be manufactured utilizing .125" aluminum sheet, 2"x2"x.125" and 1"x2"x.125" 6005A-T61 extruded structural aluminum framework with voids between the tubular structure filled with 2" thick block polystyrene and covered with .125" laminated Luan. These panel components shall be integrated utilizing high strength adhesives. The aluminum sheet shall be attached to the wall structure with a Methacrylate adhesive with at shear and tensile strength of approximately 2,215 psi and a tensile modulus of 157,090 psi. The block foam and ply shall be attached with a urethane adhesive with a minimum tensile strength of 300 psi. The entire assembly shall be vacuum cured to form a solid, penetration resistant composite body panel. In no case shall screws, rivets, VHB tape or any other mechanical fasteners be used to attach the skin to these structural members.

The four vertical corners shall be configured so that the actual corner wall extrusions overlap allowing the wall sections to have full, vertical seam welds outside. This offset will also allow for the four vertical corners to be stitch-welded in 5" – 6" increments every 5" along the full vertical contact point inside.

Similarly, the four sidewall structures at the roofline shall be full seam welded around the entire horizontal perimeter of the roof and stitch-welded in 5"-6" increments every 5" around the full horizontal perimeter inside. Four full-welded vertical corner seams and four full-welded horizontal roof seams shall be covered with .090" extruded aluminum, radius corner extrusion welded at the corner caps and bonded with Lords 406-17 acrylic adhesive creating an integrated corner support column. The cast aluminum corner caps shall be seam-welded in place. All exterior body holes for lighting or other appliances shall be routed, drilled or punched prior to prime and paint process to assure complete coverage of raw metal and to reduce the possibility of paint breaks and resulting corrosion. **COMPLY: YES___ NO___**

4.4 MODULE INSULATION: The insulation material installed in the walls and ceiling shall be 2" thick, 1-lb. high density block foam insulation. The material shall be cut so that it fits securely between the structural wall members and will be installed with a full urethane coating along both sides of the material to provide a permanent bond between the outer wall skin and the interior liner. The front, side, rear and roof wall panels will be filled providing full wall insulation. Additionally, the wheel wells shall be insulated on the interior with a three-part, self-adhesive, radiant barrier material designed for extreme temperature protection and on the exterior with a two-part spray in place, adhesive foam for acoustical/thermal insulation. The underside of the side entry step well shall also be insulated with the two-part spray in place, adhesive foam. **COMPLY: YES___ NO___**

4.5 WELD QUALITY: All welds within the modular body shall meet American Welding Society codes for structural and sheet welding. All weld sites shall be cleaned prior to welding. All welds shall be free of cracks, cavitation, oxidation and foreign substances. All MIG welds shall be shielded with Argon, during the process.

COMPLY: YES___ NO___

5.0 FLOOR STRUCTURE

5.1 FLOOR MEMBERS: The floor shall be at the lowest level permitted by clearances and shall meet the floor height requirements of the current KKK-A-1822 standards. The lateral and longitudinal floor structure shall consist of 2" x 2" x .250" 6061-T6 primary structural members and 2" x 2" x .125" and 1" x 2" x .125" 6005A-T61 secondary structural

aluminum tubing. The finished assembly shall be securely welded to the wall structures and exterior compartments. There shall be .50" aluminum plates welded into the floor structure to facilitate mounting of the Technician's seat base and cot retention hardware. The floor weight bearing capability shall be compliant with AMD Standard 020- Floor Distributed Load Test, S4.3 Bariatric Load.

COMPLY: YES___ NO___

5.2 **MOISTURE BARRIER:** Over the floor substructure there shall be applied a moisture barrier of .060" aluminum skin. This skin shall be attached to the floor structure by a full bed application of a high-performance elastomeric adhesive/sealant. This adhesive bed shall be adequate to eliminate any material vibration and to completely seal the patient compartment from fumes and moisture penetrating the interior.

COMPLY: YES___ NO___

5.3 **CARBON MONOXIDE PROTECTION:** To prevent carbon monoxide penetration into the patient compartment, it is imperative that the entire underside of the modular body be sealed. All hollow corner structural members shall be sealed with either expansion foam or sealed metal plates. This completed vehicle shall be compliant with AMD Standard 007- Patient Compartment Carbon Monoxide Test.

COMPLY: YES___ NO___

6.0 SIDE STRUCTURE

SHEET: The skin covering the front, sides, and rear walls shall be a .090" single aluminum sheet with an alloy and temper strength of 5052 H32 for strength, ease of welding, and corrosion resistance. Modular bodies fabricated from "multi-piece" front, rear or side skins are not acceptable to this agency.

These panel components shall be integrated utilizing high strength adhesives. The aluminum sheet shall be attached to the wall structure with a Methacrylate adhesive with at shear and tensile strength of approximately 2,215 psi and a tensile modulus of 157,090 psi. The material shall be applied full length to every structural member prior to assembly. The block foam and ply shall be attached with a urethane adhesive with a minimum tensile strength of 300 psi. The entire assembly shall be vacuum cured to form a solid, penetration resistant composite body panel. In no case shall screws, rivets, VHB tape or any other mechanical fasteners be used to attach the skin to these structural members.

COMPLY: YES___ NO___

6.1 **SIDE STRUCTURAL MEMBERS:** The side assembly shall be reinforced vertically with extruded square aluminum structural tubing a minimum of sixteen (16) inch centers. These structural members shall be 2" x 2" x .125" 6005A-T61 structural aluminum tubing. To minimize the possibility of the extrusion bending, twisting or suffering other deformation when stressed, the extrusion shall be designed that each boxed formed corner extrusion on the sides, front, rear, and roof overlap the opposing extrusion, thus allowing for full length vertical welds on the entire outside of the body and interval welds on the inside of the body. There shall be .50" aluminum plates welded into the curbside and streetside walls structure to facilitate the mounting of a PRO4 4-point harness restraint system. Each harness restraint system/seating position along the curbside or streetside wall shall be pull tested to 6,000 pounds and passed SAE J3026 Dynamic testing. These structures shall be MIG welded together to form the body's roll cage and corner impact protection.

COMPLY: YES___ NO___

6.2 **CORNER SIDEWALL ASSEMBLY:** The four full-welded vertical corner seams and four full-welded horizontal roof seams shall be covered with .125" extruded aluminum, radius corner extrusion bonded with Lord's 406-17 acrylic

adhesive with a tensile strength of 4,650 psi and an elastic modulus of 130,000 psi creating an integrated corner support column. The cast aluminum corner caps shall be seam-welded in place. All exterior body holes for lighting or other appliances shall be routed, drilled or punched prior to prime and paint process to assure complete coverage of raw metal on edges of holes.

COMPLY: YES ____ NO ____

7.0 ROOF STRUCTURE

7.1 **PERIMETER EXTRUSIONS:** The roof's substructure assembly shall consist of perimeter extrusions, lateral roof bows, and interconnecting corner caps.

COMPLY: YES ____ NO ____

7.2 **ROOF SHEET:** The roof skin shall be .090" and will have an alloy and temper strength of 5052 H32. The skin shall be attached to the perimeter and lateral roof bows with a high strength structural Methacrylate adhesive with a tensile strength with a minimum 2,150 PSI and a tensile modulus of at least 157,090 PSI. The material shall be applied full length to every structural member prior to assembly and then cured in a vacuum bonding process to provide even and consistent adhesion of the roof skin to the structural extrusions. In no case shall the use of screws, rivets, VHB tape or other mechanical fasteners be used to attach the skin to the lateral roof bows.

COMPLY: YES ____ NO ____

7.3 **ROOF BOWS:** The lateral roof bows shall be 2" x 2" x .125" primary and 1" x 2" x .125" 6005A-T61 secondary extruded structural aluminum tubing. These structures shall be MIG welded together to form the body's "roll cage". These structural members shall be located so that the roof skin is supported on a minimum "center" distance of 14 inches. The roof bows shall interconnect with the roof side rails and be continuously welded at all contact points. In no case shall a lateral roof bow have free span of more than 42 inches. There shall be eleven (11) .125" aluminum plates welded into the roof structure to facilitate mounting of the patient compartment dome lights. There shall also be .250" aluminum plates welded into the roof structure to facilitate mounting of the overhead grab rail and a cargo net at the head of the squad bench. There shall be 1" x 2" x .125" tubing welded into the roof structure to provide secure mounting support for four CPI model 2008 folding IV hanger.

COMPLY: YES ____ NO ____

7.4 **ROOF CORNERS:** The roof rail extrusions shall be welded together along the roof bow mating walls at the corners. In addition, the outer surfaces of the roof rail extrusions shall be continuously MIG welded to cast aluminum corner castings. The castings shall have integral flanges behind the weld sites to interlock the joint. These extrusions shall be attached and sealed along their entire length with a high strength acrylic adhesive, Lord 406-17 or equivalent.

COMPLY: YES ____ NO ____

8.0 DOOR STRUCTURE

8.1 **DOOR SKIN:** The door skin shall be .090 thick 5052-H32 aluminum sheet CNC cut and formed to create a robust, crevice free environment to mirror the mating surface of the door jamb extrusions and to provide optimum paint adhesion and corrosion resistance. The formed edges shall not have elongation cracks due to forming but shall have edges uniformly rounded for strength and aesthetic appeal. The forming process will produce a door with an integral surface for mounting a pliable air core rubberized neoprene gasket around the full perimeter of the door that will seat and seal against the mating surface on the door jamb. Each door shall have a one-inch finished hole to be fitted with a black plastic, snap-in plug. The purpose of this hole, located in the door edge adjacent to the paddle handle, shall be to

provide easy access to the paddle handle internal mechanism for periodic lubrication. The CNC process will provide the cut-out for windows, latches, door panel mounting holes and hinge mounting points all machined into the finished raw door. The CNC cut fold and weld process provides a guaranteed consistent tolerance within 1/5,000th of an inch which yields a finished product that is consistently repeatable and easily replaceable in the event of damage.

COMPLY: YES ____ NO ____

8.2 **DOOR PANELS:** The inside door panels shall be made of .090" aluminum sheet laminated to match the interior of the unit. The lower approximate ¼ of the panel surface shall have a smooth aluminum kick panel installed to protect the lower portion of the door. Exposed, raw, sheared, unfinished sheet-metal edges are not acceptable. The panels shall be fastened to the door with Phillips head stainless-steel, #10-32 machine screws with rubber washers to assist in cushioning the impact of door. There shall be a 10" x 20" aluminum diamond plate kick panel installed along the lower edge of each door.

COMPLY: YES ____ NO ____

8.3 **DOOR JAMB:** The door jamb shall be an extruded aluminum extrusion measuring approximately 2.725" x 3" x .1875" wall thickness to accommodate rigid fastening of compartment door components. The corners of the extruded door jamb shall be CNC mitered, fixture fit and welded full perimeter to hold the door opening square. The mounting and access points for the Nader pins, hinges and cage nuts shall be CNC routed for precision and repetitive consistency. The door jamb shall have a full perimeter flange that shall be secured to the body side skin with 3M panel bond adhesive rated at no less than 2,150PSI. The jamb shall also be secured with ¼" x 20 Type "F" self-tapping, stainless-steel sheet metal screws installed around the full perimeter of the framed door opening into the wall structure that is welded into place around the door opening in the side wall structure. The jamb shall be CNC to accommodate the consistent placement of the TriMark cage nuts used to mount the Nader pins and for consistently locating the door hinge.

COMPLY: YES ____ NO ____

8.4 **HINGE:** All doors shall have stainless-steel, continuous, piano hinges. The pin diameter shall be .250" and staked into place to prevent drifting out of the hinge leaves. The knuckle lengths shall be 1". Alternating mounting slots shall be incorporated in the hinge to facilitate fine adjustment. The hinge attachment bolts shall be ¼" x 20 x 1" long stainless-steel Type F pan head screws. The screws shall be spaced 4 inches apart on each leaf for the full length of the hinge. The tapping points along the door and jamb shall be designed in and CNC placed for consistently repetitive production and ease of replacement. The hinges for each individual door shall be identically cut for all common door heights and the CNC process used to fabricate the door and jamb shall insure that all the door components are easily replaceable and interchangeable.

COMPLY: YES ____ NO ____

8.5 **LATCHES:** All exterior door latches shall be TriMark two stage, rotary type latches with and OEM installed emergency release mechanism that meet FMVSS 206 requirements for door locks and door retention components. The latches shall be through bolted to the door with 5/16 UNC countersink, machine type bolts and lock nuts that comply with the latch manufactures requirements. All entry doors shall have two rotary latches per door. To assure uniform latch timing and functional door reliability, only straight, 3/16" diameter rods shall connect the latches to the handle. All latch timing shall be set at the handle site. Other than at the latch site, bends in door latch rods are NOT acceptable.

The Nader pins for each door latch shall be installed through the door jamb into TriMark cage nut assemblies designed to be through bolted into the door jamb extrusion with grade 8 machine type bolts per the manufacturer's requirements.

The cage nut assembly will support the mounting nut should the Nader pin need to be removed for maintenance or service.

All single, short compartment doors shall have one rotary latch. All double doors or tall compartment doors shall have two rotary latches per door. All Nader pins shall be headed to prevent the door(s) from opening under impact.

The upper and lower rotary latches on each patient compartment entry door shall be equipped with an emergency release cable with an accessible handle secured to the interior door panel. The emergency release is for use in the event of an accident or paddle handle failure and can be used to open any of the individual entry doors.

COMPLY: YES___ NO___

8.6 EXTERIOR HANDLES: TriMark powder coated black finished, free floating exterior paddle handles shall be provided to open all doors. Blind fasteners shall be used to fasten the handles to the door. Exposed fasteners to the outside are unacceptable for security reasons. Paddle handles shall have an isolation gasket between the paddle body and the door skin. All door skin surfaces shall be CNC cut to produce a uniform fit and shall be painted prior to installation of the hardware. The handle shall be long enough to accommodate four gloved fingers for door actuation. All paddles on single doors and leading double doors shall be locking type and keyed the same. Trailing doors shall have non-locking paddle handles mounted on the interior door panel. The inner side of all exterior handles shall have a strip of 3M Safety Grip material installed to provide a slip resistant surface in bad weather. When locked, the paddle handle shall "float" to prevent unnecessary pressure being applied which may damage the handle and function as a signal that the handle is locked.

The rotary latches for each door shall be fit with metal rods, individually clipped to both the latches and the paddle handles. The rods shall be designed to be adjustable; however, they will be secured when adjusted so that they cannot voluntarily move. The door latching assemblies shall be fully tested to comply with FMVSS 206 requirements including 30G testing, no exceptions. A copy of the testing certificate validating the door system and testing shall be provided with the bid.

COMPLY: YES___ NO___

8.7 INTERIOR HANDLES: TriMark powder coated black interior paddle handles shall be supplied on all module entry doors. A Lock/Unlock lever shall be installed and be clearly marked Lock/Unlock. As a safety feature, the interior paddle handles on the curbside and rear entry doors shall be capable of unlocking and opening the door without switching the Lock/Unlock lever. The interior handles shall be chrome plated.

COMPLY: YES___ NO___

8.8 WINDOWS: All entry doors shall be equipped with an upper window. The curbside entry door shall have a fixed pane window with a nominal area of 320 square inches. The rear access doors shall each have a fixed pane window with a nominal area of 320 square inches. All windows shall have anodized frames and blind inner mounting ring screws, fastened from the inside. The exterior portion of the frame shall have a full perimeter seal mated against the door skin. All glass shall be tinted safety glass compliant with FMVSS 205.

COMPLY: YES___ NO___

8.8.1 Privacy tint, dark vinyl applied to all three entry module entry door windows. Tint to be black out 3% over normal tinted windows on modular doors.

COMPLY: YES___ NO___

8.9 **DOOR CHECKS:** All compartment doors (except the Optional Compartment #7 door) and the curbside entry doors shall be equipped with a heavy-duty gas strut door check (hold open). The gas strut shall keep positive pressure on the door in the open and closed position. Door check brackets shall bolt through an overhead structure to provide a solid attachment to the door frame and through a .250" support plate welded into the door. All doors shall open 90 to 110 degrees, unless otherwise specified by the end user. **COMPLY: YES___ NO___**

Rear access doors shall open at least 150 degrees. The door checks shall be 2-piece, heavy duty, cast aluminum, grabber type. The door shall have a ½" thick cast aluminum loop that plunges into a positive rubber/cast aluminum socket mounted on the body. Each component of the door checks shall be insulated from the skin with a rubber gasket. Each door-check component shall be rigidly mounted on the door or body with ¼" x 20 x 1" stainless-steel machine screws through .250" plates permanently mounted behind the skin to stabilize the grabber. **COMPLY: YES___ NO___**

8.10 **ENTRY DOOR ASSIST HANDLES:** All entry doors shall be equipped with V-Style Handicapped/Brushed Stainless 1.25 with Radius Ends. The door handles shall be fastened directly to the horizontal door structure that is welded into the door assembly. **COMPLY: YES___ NO___**

8.11 **DRIP RAILS:** A drip rail shall be provided over each compartment to prevent water roll off from spilling into the opened compartment door. Drip rails shall be attached with double-sided adhesive tape for ease of replacement. Full height compartments shall be exempt because the perimeter roof rail drip rails cover these compartments. **COMPLY: YES___ NO___**

8.12 **ENTRY DOOR:** Hurricane straps shall be mounted on the side entry door. **COMPLY: YES___ NO___**

9.0 **COMPARTMENT STRUCTURE & CONFIGURATION**

9.1 **MATERIALS:** All exterior compartment walls, back and floor shall be constructed of smooth aluminum and coated with a rubberized polyurethane coating. The ceilings and floor components shall be CNC cut, formed and welded to provide overlapping joints. The floors and ceilings are both welded and seam sealed as necessary to the walls and back prior to applying the rubberized urethane coating. The compartment shall be designed so that the floor to the compartment will be below the lower edge of the door jamb. **COMPLY: YES___ NO___**

9.2 **COMPARTMENT CONFIGURATION:** The exterior compartments on this vehicle shall be as illustrated in the drawings attached to this Specification:

Drawing A- Curbside

Drawing B- Streetside

9.3 **VENTILATION:** All exterior compartments shall have louvered, automotive style ventilation to the exterior, underside of the vehicle. The oxygen cylinder compartment shall be louvered through the door with a minimum of 9 square inches of free-vented area in compliance with KKK-A-1822F, 3.11.3 as well as the underbody ventilation. **COMPLY: YES___ NO___**

9.4 **OXYGEN COMPARTMENT:** Smooth Aluminum body, ADP interior door panel, Door w/gas-strut hold-open. A Zico Lift shall be provided to secure vertically and store a Steel O2 cylinder. Compartment #1 shall be approximately: 16.75"W x 69.75"H x 15.75"D. **COMPLY: YES___ NO___**

9.5 **#2 STORAGE COMPARTMENT:** This compartment shall be located just aft of the O2 compartment on the streetside of the module. It shall be configured for general storage or as specified by this agency. Backer Plate shall be added at lower half of door to mount equipment on to interior door panel. 1/4" stock weld shall be used in back. Mount (1) portable "D" bottle bracket and (1) Fire Extinguisher to interior door panel towards center/bottom of door.

NOTE: Mount (1) portable "D" bottle bracket and (1) Fire Extinguisher to interior door panel towards center/bottom of door. See option in Oxygen section for bracket.

SS center, Drop Pan, 5" pan recess in tub floor for Stair Chair storage.

Fire Extinguisher: Mount (1) standard 5 Lb. extinguisher and red mounting bracket.

Specify Location: Compt. #2 interior door panel next to the "D" bottle bracket.

Compartment #2 shall be approximately: 30.75"W x 34.5"H x 15.75"D.

COMPLY: YES___ NO___

9.6 **#3 STORAGE COMPARTMENT:** This compartment shall be located aft of the rear wheel well on the streetside of the module.

Drop Floor, 5" for SPARE TIRE storage in 34" W tub; Seat Belt retainer strap across mid-point of inboard wall anchored with footman loop on inboard/back wall, not on side walls.

NOTE: Will contain UV-C light control box on right hand wall at ceiling. Make sure location clears tire.

Compartment #3 shall be approximately: 34.75"W x 34.75"H x 18.75"D.

COMPLY: YES___ NO___

9.7 **#4/5 INSIDE/OUTSIDE COMPARTMENT:** This compartment shall be located at the forward most curbside of the module. It shall be configured to provide exterior access to the upper section of the interior ALS cabinet and the optional battery storage area located below the floor level of the ALS storage. There shall be a separate access door located below the floor level for maintenance and service to the optional vehicle's battery storage area.

Compartment #4 shall be approximately: 18"W x 60"H.

COMPLY: YES___ NO___

9.8 **#6 BACKBOARD COMPARTMENT:** This compartment shall be located at the rear most curbside of the module. It shall be configured to provide exterior access to the backboards with an inside/outside access window. A fixed shelf with diamond aluminum finish and a 1" upturned lip shall be positioned in the upper right hand corner of the compartment.

NOTE: Install the standard/upper backboard strap so that it is positioned across midpoint of L-shaped area. Customer will store an Auto-Pulse in this area with inside access. Auto-Pulse size is 3" thick x 32"H x 16"w.

Compartment #6 shall be approximately: 23.75"W x 24.25"H x 15.5"D.

COMPLY: YES___ NO___

9.9 **#7 COMPARTMENT:** This compartment shall be located between the curbside rear wheel well and compartment #6. It shall be open storage with a single access door with gas strut hold-open.

Compartment #7 shall be approximately: 12.75"W x 75.75"H x 19"D.

COMPLY: YES___ NO___

9.10 **STEP WELL:** An intermediate, full depth step to the patient compartment floor shall be provided at the curbside entry door. The step well shall include a smooth aluminum plate step body with a Dri-Deck insert step and rubberized polyurethane walls. The step insert shall provide a step surface that is flush with the lower jamb of the side entry door. The step shall have a tread dimension of not less than 10 inches. The step well shall be illuminated by an LED light head located on the forward wall of the step well. There will be a formed stainless-steel threshold trim installed around the upper edge of the step well. The threshold will be installed with a high strength sealant adhesive to eliminate the need for mounting screw penetrations and to provide a permanent full perimeter seal. 3M safety step material shall be installed along the top of the threshold to provide a slip resistant surface. **COMPLY: YES___ NO___**

9.11 **STREAMLIGHT in STEP WELL:** (1) Fire Vulcan LED Lantern. Fire Vulcan LED Vehicle Mount system 12V DC - Orange. UPC:080926-44451-5.

Specify Location: Side Entry Step Well, at top step bench side.

NOTE: Hard wire.

COMPLY: YES___ NO___

9.12 **FIRE EXTINGUISHER:** Mount (1) standard 5 Lb. extinguisher and red mounting bracket.

LOCATION: Install (1) of the two standard/supplied extinguishers.

Specify Location: Side Entry Step Well closest to door opening, at lowest step in stepwell, bench side.

COMPLY: YES___ NO___

9.13 **MANUAL STEP:** A Zico Quic-Step Manual vehicle step, 24" wide. Mount below the curbside entry door with a 4 7/8" drop. **COMPLY: YES___ NO___**

9.14 **COMPARTMENT DOORS:** Hurricane straps to be mounted on module compartment doors #1, #2, #3, #4, #5, #6 & #7. Requires 4" x .125" stock backer plate in door. **COMPLY: YES___ NO___**

9.15 **COMPARTMENTS:** All exterior compartments to have Dri-Dek, floor liner installed. Color shall be black.

COMPLY: YES___ NO___

10.0 ANTI-CORROSION/ELECTROLYSIS

10.1 **EXTERIOR FASTENERS:** Dissimilar metal contact is known to cause corrosion at fastener sites. All exterior device fasteners, especially light fasteners, shall not contact the painted aluminum surface. All fasteners that are NOT aluminum or plastic bodied are considered Dissimilar. Each hole drilled after the prime and paint process shall be treated with an Electrolysis Corrosion Control compound prior to installation of the mounting screws. All mounting screws shall be stainless-steel and shall be coated with the Electrolysis Corrosion Control compound prior to installation.

COMPLY: YES___ NO___

11.0 REAR BUMPER

11.1 **FRAMING:** The rear step bumper shall meet or exceed current KKK-A-1822 requirement 3.9.6 and be compliant with AMD Standard 018. The bumper shall be a minimum 1/8" welded tubular steel frame with a 1/4" flange designed to be bolted directly to the chassis frame without cutting, drilling or welding. The frame shall be bolted with a minimum four 1/2" steel bolts, washers and nylon lock washers on each side. In addition, the bumper will be configured so

that the bottom of the bumper shall be mounted below the body skirt-line. The steel bumper frame shall be powder coated black for a durable, corrosive resistant finish.

COMPLY: YES___ NO___

11.2 **CENTER STEP:** A flip up step shall be provided to facilitate access to the patient compartment floor loading and unloading the stretcher. The step shall be as wide as the rear access door jamb. The step shall have a grip strut surface for aggressive traction. Snow and ice shall not compromise the level of traction on the center step. A stainless-steel piano hinge shall have a staked in, 1/4" diameter pin, 1" knuckles and Type-F 1/4"x 20 stainless-steel bolts every four inches.

COMPLY: YES___ NO___

11.3 **OUTER BUMPER PODS:** The step bumper shall have an aesthetically pleasing appearance. The outer bumper pods shall be polished aluminum diamond plate. The outer corners shall be rounded to eliminate sharp corners around the working area. Each pod shall have a heavy-duty rubber rear dock bumper attached to further protect the bumper.

COMPLY: YES___ NO___

12.0 BODY PROTECTION

12.1 **FRONT BODY STONE GUARDS:** The front of the body shall have protection plates made of aluminum diamond plate. 30" High corner guard and 30"-High front wall guard on Driver's side & 34" on Passenger's side installed from the corner guard and extending behind OEM cab.

COMPLY: YES___ NO___

12.2 **REAR BODY KICKPANEL:** An aluminum diamond plate kick panel shall run from rear corner post to corner post and house a recessed, cast aluminum, license plate holder. The kick panel shall be 12" in height and shall extend downward from below the rear door jamb to the bottom edge of the body. The corner posts shall have 12" high formed diamond plate protection panels.

COMPLY: YES___ NO___

12.3 **LOWER BODY RUB RAILS:** The entire skirt-line of the body, forward and aft of the rear wheels shall have extruded aluminum "C" channel skirt rails to protect the edge of the lower body. Each rail shall be chamfered 45 degrees at each end. The rails shall be mounted with .250" x 20 stainless-steel, counter sink machine screws with a 3/16" neoprene spacer between the rail and the body. There will be a 3/4" reflective stripe installed down the center of the rail so that the hardware shall not have exposed fasteners when viewed from the standing position.

COMPLY: YES___ NO___

12.4 **REAR ENTRY DOOR THRESHOLD:** At the rear entry doors, a full width, formed, stainless-steel jamb protection plate shall be provided to prevent the cot frames from chipping the body paint. The threshold shall extend in a single piece from 6" inside the rear door opening along the surface edge down to 1/2" below the bottom of the lower edge of the door jamb. The threshold will be mounted with a sealant/ adhesive to eliminate the need for screws and to provide a sealed edge at the floor level. 3 M Safety Walk materials will be installed along the full width of the threshold step surface to provide a safe, slip resistant step area.

12.5 **SIDE ENTRY DOOR STEPWELL/THRESHOLD:** A rubberized urethane coated smooth aluminum step shall be installed at the side entry door. The threshold transition between the side entry step well and the patient compartment

floor shall be formed, bright aluminum diamond plate. The threshold shall have a high-quality anti-skid material applied in full width strips to provide a slip resistant step into the patient compartment. **COMPLY: YES___ NO___**

12.6 **MODULE FENDER FLARES:** The rear fender flares shall be formed stainless-steel. The fender flares shall be isolated from the body surface by a closed-cell rubber gasket and through bolting around the wheel well opening with 1/4"-20 stainless-steel pan head bolts coated with an anti-corrosion chemical. **COMPLY: YES___ NO___**

12.7 **TOW EYES:** Two eyes will be frame-mounted through the rear kick plate. **COMPLY: YES___ NO___**

12.8 **SPLASH GUARD:** A Stainless-Steel Plate shall be installed below the fuel fill and DEF fill. **COMPLY: YES___ NO___**

12.9 **REAR ENTRY DOOR WASTE:** Powder coated bracket, POWDER COATED BLACK, to hold a 3-gallon trash can. Include trash can PL17159 Wastebasket, Rubbermaid #FG2550 3-Gallon.

NOTE: Mount bracket 1' above S.S kickplate on Rear, Curbside entry door inner panel, off center towards hinge side of door as much as possible to clear cot. **COMPLY: YES___ NO___**

13.0 CABINetry

13.1 **SUBSTRATES:** The interior cabinets and components shall be constructed of high quality, domestic, A-C grade plywood. The exposed layers shall be hardwood on both sides of the sheet. The layers shall be free of voids between layers. Cabinet interiors shall be made from 3/8" or 1/2" thick, 5-ply plywood determined by the application for each. Bench lids, doors and the primary cabinet fascia shall be made from 3/4" thick, 7-ply plywood.

COMPLY: YES___ NO___

13.2 **CABINET INTERIOR FINISH:** Cabinet interior shall be laminated with high gloss grey pampas colored, high impact, abrasion resistant laminate. The contact adhesive shall be a high bond contact adhesive, specifically designed to bond plastic laminates to wood. Painted cabinet interiors are not acceptable. The interior corners of the cabinets shall be sealed to prevent contamination and to facilitate cleaning.

COMPLY: YES___ NO___

13.3 **FLOOR AND SUBSTRATE:** The sub floor of the module shall be 3/4" thick, 7-ply, exterior grade, A-C plywood. The vinyl floor covering shall be a Lonseal solid vinyl material, Loncoin II to be determined at the pre-construction meeting.

COMPLY: YES___ NO___

13.4 **LAMINATE:** A high impact, phenol backed, high impact, and abrasion resistant laminate shall be used. The laminate shall be selected from the ambulance manufacturer's samples. The material shall be standard grade. This material as well as all interior components shall meet or exceed F.M.V.S.S. #302. **COMPLY: YES___ NO___**

13.5 **CABINET ASSEMBLY:** To maximize fastener bite, cabinet substrate parts shall be stapled with pneumatic fired equipment. Staples shall be placed on two-inch intervals along the corner joints. In addition to staples, the entire cabinet assembly must be screwed together with a minimum #8 screw size and a length not less than 2 times the thickness of the pierced substrate. Screw heads shall be counter-sink type and driven flush. Cabinet fascia shall be CNC cut or drop

cut to eliminate the use of cleats or stick built components. The use of stick-built components or dowel pin type assembly to create cabinet components will not be acceptable. **COMPLY: YES___ NO___**

13.6 **CABINET TRIM:** All trim throughout the interior conversion shall be anodized aluminum or formed stainless-steel. All exposed corners within the patient compartment shall have either padded or rounded corners. Excess adhesive-sealant shall be removed. Intermittent placement of screws is not acceptable due to cleaning difficulty inherent in screw head design. **COMPLY: YES___ NO___**

13.7 **FIT AND FINISH:** Mitered joints throughout the interior conversion shall have a gap-less, hairline fit. Openings and misalignments at the corners are not acceptable. Misapplied trim to cover manufacturing mistakes is not an acceptable solution to poor design and/or workmanship. Doors shall be warp free. Sliding polycarbonate door assemblies shall be scratch free and all edges shall be smooth and free of saw marks and sharp edges. Cabinet to cabinet joints shall not require welting to create a finished/well-fit look. Cabinets shall fit tightly against the ceiling without the use of vinyl covered trim pieces to cover the seam between cabinets and ceiling. The fine line seam between the cabinets and the ceiling will be sealed with a flexible, permanent sealant/adhesive. **COMPLY: YES___ NO___**

13.8 **FUNCTION:** Doors and drawers shall fit the opening. Flush fitting doors shall have even door to opening spacing around the perimeter. All doors shall open and close without binding. Drawers shall slide in and out freely, without drag. All drawers shall be mounted with side mounted, full-extension drawer slides, rated at no less than 100 pounds per pair. All hinged wood-core doors shall have positive latches. **COMPLY: YES___ NO___**

13.9 **SLIDING POLYCARBONATE DOORS:** All interior cabinets requiring the sliding, transparent polycarbonate door assembly shall have a mitered, anodized aluminum frame. The polycarbonate material shall be ¼" thick.

Each sliding door shall be fitted with an anodized, full height extruded aluminum door handle. The door pull extrusion shall also reinforce the ends of the doors. The door track/frame extrusion shall incorporate a flocked natural rubber track insert to prevent the doors from sliding free during transit. All extrusions shall be anodized.

COMPLY: YES___ NO___

13.10 **HINGED ACRYLIC DOORS:** All interior cabinets requiring a hinged, transparent door assembly shall have a ½" smoked acrylic door with either a full-length stainless-steel piano hinge or a combination of Southco constant torque hinges and a latch to secure each door. **COMPLY: YES___ NO___**

14.0 CABINET CONFIGURATION

14.1 **STREET SIDE:** The cabinet configuration and design shall provide a product that has been tested and is in full compliance with the current KKK-A-1822, AMD and SAE test requirements. The primary configuration of the streetside main wall will include a CPR seat. The cabinets shall be easily accessible over the primary cot. The cabinet configuration and dimensions will be described in the CAD drawings attached to this Specification and as follows:

COMPLY: YES___ NO___

14.1.1 **Streetside rear upper cabinet "A"** will be at the upper rear location. The cabinet shall be approximately 17.75"H x 36.25"W x 18"D and will have sliding Polycarbonate doors and one adjustable shelf.

COMPLY: YES ___ NO ___

14.1.2 **Streetside rear middle cabinet "A2"** will be below cabinet "A" and shall be approximately 24.5"H x 23"W x 18"D and will have sliding Polycarbonate doors and one adjustable shelf.

COMPLY: YES ___ NO ___

14.1.3 **Streetside rear monitor shelf** aft of the CPR seat shall be approximately 22"W x 22"H with one 125VAC receptacle and one 12VDC receptacle.

COMPLY: YES ___ NO ___

14.1.4 **Streetside CPR seating** area shall be approximately 32"W. The CPR seat shall include an EVS PRO4 belt position with single click, automotive style, wall mounted POD system with black seat belt harness and shoulder comfort pad accompanied by a 3" seat cushion. The seat base shall be equipped with a TriMark near flush mount black latch and hinged lid to access storage below the seat. There shall be a formed, welded and powder coated white cover cap on the interior of the latch to prevent damage to any item stored below the seat.

COMPLY: YES ___ NO ___

14.1.5 **Streetside upper "C"** cabinet shall be above the forward action area shelf and shall be approximately 16.75"H x 35.25"W x 15"D with sliding Polycarbonate doors and one adjustable shelf.

COMPLY: YES ___ NO ___

14.1.6 **Streetside Action Area shelf** shall be approximately 44"L x 16.75"D with 21.75" clearance above the shelf.

COMPLY: YES ___ NO ___

14.1.7 **Forward Action Area cabinet**, located in A.A. wall between countertop and upper cabinet C. Cabinet to be full height of Action Area, 4.375" inside depth and 9" inside width with 3- fixed shelves evenly spaced, single right hinged 1/2" Acrylic door hinged with non-locking two-point paddle latch.

COMPLY: YES ___ NO ___

14.2 **CURB SIDE:** Wood squad bench with lid and BOX-OUT around compt. #7, TriMark latch for lid, full length seat cushion, standard (2) EVS PRO-4 seating positions, full height stainless steel kick panel on face of bench and special DUAL sharps containers drop-in with an aluminum, powder coated red, hinged lid. The (2) sharps containers are model Kendall Covidien 8920SA 2-Gallon with rotor lid. The cabinet configuration and dimensions shall be as depicted in the cabinet drawings attached to this specification and as described below.

COMPLY: YES ___ NO ___

14.2.1 **Squad bench:** Shall have two (2) EVS PRO4 belt positions with single click, automotive style, wall mounted POD systems with black seat belt harnesses and shoulder comfort pads accompanied by a full-length seat cushion. The belts shall restrain two seated occupants or one secondary patient, on a back board. All seat belts and anchorages shall comply with F.M.V.S.S. 209 and 210. There shall be a drop-in Sharps/Waste access disposal area located at the head of the squad bench. There shall be a hinged aluminum, powder coated red access door on the forward end of the HDPE lid with a separate container for each. The hinged will have an assist handle and a "Bio-Hazard" symbol affixed to the hinged lid.

The HDPE squad bench lid shall utilize gas struts as support when opened and shall have a powder coated, black TriMark recessed paddle latch to hold the lid in the closed position. The latch cover on the interior of the squad bench will be formed, welded and powder coated white and will be designed to help protect the contents of the squad bench.

COMPLY: YES ___ NO ___

14.2.2 **Squad Bench Overhead Cabinet**, with (2) flip-up 1/2" Acrylic doors, (1) Two Point Paddle latch per door and Austin torque hinges. **COMPLY: YES___ NO___**

14.2.3 **Cabinets**: Inside/Outside Access, to Compartment #6 with single, hinged 1/2" Acrylic door with Eberhard two-point paddle style latch. Locate on LH, aisle side of Compartment #6 interior cabinet wall for access to shelves in Compartment #6.

NOTE: Special dimensions for clear opening - This opening shall be a minimum of 4" wide x 34" tall in order to fit an AutoPulse w/carrying case through and store in compartment #6. **COMPLY: YES___ NO___**

14.3 **RIGHT FRONT CABINET**: The right front cabinet is hereinafter known as "ALS Cabinet". The ALS cabinet shall be finished in color keyed laminate. The cabinet shall be configured for ease of access from either the interior or the exterior of the ambulance. The cabinet shall be configured as follows and per the CAD drawings attached to this bid specification. **COMPLY: YES___ NO___**

14.3.1 **Upper cabinet** configuration shall house the HVAC and return air filter. There shall be a removable air distribution panel and a separate return air grille with HEPA air filter. **COMPLY: YES___ NO___**

14.3.2 **Upper intermediate cabinet** shall be configured with dual/hinged, 1/2" acrylic doors and (1) adjustable shelf. Each of the acrylic doors will be secured by an Eberhard two-point, push to close paddle latch. **COMPLY: YES___ NO___**

14.3.3 **Lower locking cabinet** shall have a Medi-Kool Stainless Steel Model 747 SS with back-mounted compressor and 1" mounting flange with controls. Order with door hinged on RIGHT side. Unit to have COMPX key lock and standard handle (COMPX-REG-S-V-5). Install per manufacturer's instructions regarding power supply, fan, and ventilation. Control panel for unit installed on ALS side passthrough area.

NOTE: Make sure cabinet build prints have the ventilation on back wall and outboard side wall of ALS cabinet using louvered panel. **COMPLY: YES___ NO___**

14.3.4 **ELECTRICAL NOTE**: Must have a disconnect switch in the electrical cabinet for shutting unit off when out of service or for maintenance. **COMPLY: YES___ NO___**

14.4 **BULKHEAD CABINETRY**: The upper bulkhead cabinets shall include the A/C-heater evaporator, the return air filter system and the electrical cabinet above the pass-through. The electrical cabinet shall be hinged on the left-hand side and will include two louvered vents and a LifeDefender, push to close latch. **COMPLY: YES___ NO___**

14.5 **ACTION AREA COUNTERTOP**: The countertop surfaces shall be solid surface material, 1st and 2nd Action Areas. Color: Grey with Black top and full perimeter accent color. To extend over the edge of cabinet main. The edge of the action area shall have a lip to prevent items from sliding to the floor. Action areas will be located on both sides of the CPR seat. The action area forward of the CPR seat will hereinafter be called the EMSP Action Area and the action area to the rear of the CPR seat will hereinafter be called the LifePak Action Area. The LifePak Action Area shall be approximately 21.5"W x 22"H or as shown on the attached CAD drawings. **COMPLY: YES___ NO___**

14.6 **TECHNICIAN'S SEAT:** The Technician's seat shall be an EVS 1880 Child Safety Seat, (1) Technician's Seat with 10° back. Rear facing automotive style seat to include a Pro-4 black belt system, comfort shoulder padding and the child safety seat system. EVS Seat Base, EVS Swivel Base-2 for child safety seat with 4 point seat belt system. The Technician's seat shall be fastened with Grade 8 fasteners through the top of the seat base which is secured with Grade 8 fasteners through the floor and through 1/2" aluminum mounting plates with flat washers and Grade 8 nylon locking nuts. The technician's seat and seat base shall comply with FMVSS 207/210. **COMPLY: YES___ NO___**

14.7 **PASS-THRU CABINETS:** Located in the pass-thru of the module behind the Technician's Seat shall be two additional storage cabinets. These cabinets shall each be as shown in the CAD drawings attached to this Specification and as follows: **COMPLY: YES___ NO___**

14.7.1 **Upper cabinet "D"** shall be the first cabinet below the upper bulkhead cabinets. It will be approximately 23.5"H x 21"W x 17.125"D. The cabinet will have one hinged 3/4" plywood door with a LifeDefender, push to close latch. This cabinet shall be configured for general storage. **COMPLY: YES___ NO___**

14.7.2 **Lower cabinet "E"** shall be approximately 23.5"H x 21"W x 17.125"D. The cabinet will have one hinged 3/4" plywood door with a LifeDefender push to close latch. This cabinet shall be configured for general storage. **COMPLY: YES___ NO___**

14.8 **OCCUPANT HEAD CLEARANCE ZONES:** All designated occupant seating positions in the vehicle described in the Specification shall be in compliance with AMD Standard 025- Measuring Guidelines: Occupant Head Clearance Zones. **COMPLY: YES___ NO___**

14.9 **I.V. HANGERS:** There shall be four flush-mount, CPI Model #2008 IV hangers mounted (1) each at the torso area over the cot and squad bench and (1) each at the knee area over the cot and squad bench. They shall be mounted so that in the event of a forward collision, the IV hanger will fold up upon impact. **COMPLY: YES___ NO___**

14.10 **I.V. CLIP:** There shall be two Perko wall mount fender clips. One will be mounted on the streetside ceiling just forward of the cpr seat, near the corner of the action area overhead cabinet; one shall be mounted on curbside wall just under the squad bench overhead cabinet. **COMPLY: YES___ NO___**

14.11 **MAIN CABINET STAINLESS STEEL WALL:** Full front to rear stainless streetside kick panel from the top of the roll-up floor trim up to both action area countertops. **COMPLY: YES___ NO___**

14.12 **DRAWERS:** Drawers, (2) Stacked aluminum build, pull-out drawers with HD slides stacked below the Action Area countertop. Drawers will have the following inside dimensions: 9.8"W x 3"H x 16.8"D and (1) non-locking, LifeDefender latch on each drawer. **COMPLY: YES___ NO___**

15.0 UPHOLSTERY

15.1 **UPHOLSTERY MATERIALS:** All padding and upholstered seating shall be covered in vacuum formed cobalt blue vinyl. Sewn, exposed seams in the seat covers and cushions are not acceptable.

The color shall be selected from the manufacturer's high quality color samples to coordinate with the laminate and A solid surface countertop selections.

COMPLY: YES___ NO___

15.2 **SEAT / BACKREST CORE MATERIAL:** The foam shall meet Federal Specification current KKK-A-1822 requirements. All seating and trim materials shall meet or exceed FMVSS 302- Flammability of Interior Materials.

COMPLY: YES___ NO___

16.0 INTERIOR HARDWARE

16.1 **OVERHEAD ASSIST RAIL:** There shall be one (1) assist rail mounted in the ceiling area of the patient compartment. This rail shall be naturally accessible to assist working technicians in maintaining their balance. The rail shall meet or exceed Federal Specification current KKK-A-1822 requirement and comply with AMD Standard 008- Patient Compartment Grab Rail Static Load Test. The rail shall be 1.25" diameter, 100% brushed stainless-steel radius formed at each end and 72" long. The assist rail shall be mounted with 1/4" x 20 stainless-steel machine screws tapped into 1/4" plates welded into the ceiling structure. The rail shall be located (1) over the primary patient.

COMPLY: YES___ NO___

16.2 **COT RETENTION DEVICE, PRIMARY COT & STAIR CHAIR:** Install a dealer/manufacture supplied Stryker Power Load, Power Pro II and Stair-PRO stair chair. Mounting Location Power Load shall be centered. The floor mounting plates shall be recessed into the floor and will be secured with 3/8" grade 8, socket head machine screws tapped through 1/2" aluminum plates welded into the floor structure. The installed cot retention device shall be tested and in full compliance with SAE J-3102 Ambulance Patient Compartment Structural Integrity Test to Support SAE J3027 Compliant Litter Systems.

Supply Stryker Power Pro II Cot 650705550001- High configuration: Include options
650700450102 Assembly, Power Cord, North AM,
650700450301 Assembly, Battery Charger
650707000002 Kit, Alvarium Battery, Service.

Supply Stryker Power Load System: Include
639005550001 Supply Stryker Stair Chair: Include options
6252000000 Stair-PRO Model 6252
6252009001 Stair-Pro Operations Manual
6250001162 In-Service Video (DVD)
6252026000 Common Components
6250021000 2 Piece ABS Panel Seat
6250160000 Polypropelene Restraint Set (Plastic Buckles)
6252022000 Main Frame Assy Option
6250024000 Standard Length Lower Lift Handles
6252027000 Footrest Option
6252041000 Vinyl Head Support
6250140000 O2 Bottle Holder

6252024000 No IV Clip Option.

COMPLY: YES___ NO___

16.2.1 **STRYKER PRO CARE CONTRACT:** Dealer/manufacture shall supply a Stryker PROCARE contract for the Power Load, Power Pro II and Stair-PRO stair chair. The term of the contract shall be 84 months.

POWERLOAD-PROCARE ProCare – Parts, Labor, Travel, Preventative Maintenance, Battery Service, 84 months.

POWERLOAD-PROCARE ProCare – Parts, Labor, Travel, Preventative Maintenance, Battery Service, 84 months.

STR-CHAIR-PROCARE ProCare – Preventative Maintenance, 84 months.

COMPLY: YES___ NO___

16.3 **ENTRY DOOR ASSIST RAIL:** This rail shall be naturally accessible to assist working technicians entering and exiting the vehicle. The rail shall meet or exceed Federal Specification KKK-A-1822F. The rail shall be 1.25" diameter, 100% brushed stainless-steel radius formed at each end and 14" long. The assist rail shall be mounted with 1/4" x 20 stainless-steel machine screws tapped into 1/4" plates welded into the door support structure. The rail shall be horizontally located just below the window level on each entry door.

COMPLY: YES___ NO___

16.4 **DEFIBRILLATOR MOUNT:** Technimount, Zoll "X" Series Pro 25 Bracket (100-12-XZ-HD) and Standard Base (100-20-UN) installed on 2nd action area shelf with aluminum backer plate and solid surface spacer for swivel base.

COMPLY: YES___ NO___

16.5 **SHARPS:** Tilt-Out cabinet below the 2nd action area with LifeDefender latch. This tip-out to be designed for a special sharps container, model Kendall Covidien 8920SA 2-Gallon with rotor lid.

COMPLY: YES___ NO___

16.6 **GLOVE BOX HOLDERS:** (3) with hinged, black 11ga steel powder-coated door, above Curbside Entry Door. Does your bid comply?

COMPLY: YES___ NO___

16.7 **GLOVE BOX HOLDERS:** (3) with hinged, black 11ga steel powder-coated door, in cabinet above rear entry doors.

COMPLY: YES___ NO___

16.8 **CARGO NET:** Head of squad bench. Squad Bench to accommodate mounting plate and cover secured to wall structure.

COMPLY: YES___ NO___

16.9 **ZOLL MEDICAL EQUIPMENT:** ZOLL601-2231111-01 X Series Advanced Monitor/Defibrillator – 12-Lead ECG, Pacing, SpO2, EtCO2, BVM, NIBP, CPR Expansion Pack, Remote View

Includes: TBI Dashboard, 4 trace tri-mode display monitor/ defibrillator/ printer, advisory algorithm, advanced communications package (Wi-Fi, Bluetooth, USB cellular modem capable) USB data transfer capable and large 6.5in (16.5cm) diagonal screen. Accessories Included: MFC cable and CPR connector, A/C power cord, One (1) roll printer paper, 6.6 Ah Li-ion battery, Operators Manual, Quick Reference Guide, and One (1)-year EMS warranty.

Parameter Details: Real CPR Help - Dashboard display of CPR Depth and Rate for Adult and Pediatric patients, Visual and audio prompts to coach CPR depth (Adult patient only), Release bar to ensure adequate release off the chest, Metronome to coach rate for Adult and Pediatric patients. See-Thru ® CPR artifact filtering • Interpretative 12-Lead ECG

(Full 12 ECG lead view with both dynamic and static 12-lead mode display. 12-Lead OneStep ECG cable - includes 4-Lead limb lead cable and removable precordial 6-Lead set) • ZOLL Noninvasive Pacing Technology • Real BVM Help: Dashboard provides real-time ventilation feedback on both volume and rate for intubated and non-intubated patients. AccuVent Cable included. (Accuvent disposable sensors sold separately) • Welch Allyn NIBP with Smartcuff. 10 foot Dual Lumen hose and SureBP Reusable Adult Medium Cuff • Masimo SpO2 & SpCO with Signal Extraction Technology (SET), Rainbow SET® • EtCO2 Oridion Microstream Technology. Microstream tubing set sold separately

- 16.9.1 CPR Stat-padz HVP Multi-Function CPR Electrodes - 8 pair/case.
- 16.9.2 OneStep Cable, X Series
- 16.9.3 CPR-D-padz and CPR Stat Padz Connector
- 16.9.4 OneStep Pediatric CPR Electrode (1 pair)
- 16.9.5 Microstream Advance Adult-Pediatric Intubated CO2 Filter Line, Short Term Use, Box of 25
- 16.9.6 Microstream Advance Adult Oral-Nasal CO2 Filter Line With O2 Tubing, Short Term Use, Box of 25
- 16.9.7 Accuvent Flow Tube (Box of 10)
- 16.9.8 RD Rainbow SET MD20-04 EMS Patient Cable, 4ft
- 16.9.9 Masimo LNCS-II Rainbow DCI 8λ SpCO Adult Sensor, 3ft
- 16.9.10 Masimo LNCS-II Rainbow SpCO Sensor, Pediatric, 3 ft
- 16.9.11 Six Hour Rechargeable, SurePower II Smart Battery, Quantity (2)
- 16.9.12 Single Bay Charger for the SurePower and SurePower II batteries, Quantity (2)
- 16.9.13 Paper, Thermal, w/Grid, BPA Free (Box of 6)
- 16.9.14 X Series Carry Case, Premium
- 16.9.15 Welch Allyn REUSE-13-2MQ Cuff, Thigh, 2-Tube Twist Lock connector
- 16.9.16 Welch Allyn REUSE-12-2MQ Cuff, Lg Adult, 2-Tube Twist Lock connector
- 16.9.17 Welch Allyn REUSE-10-2MQ Cuff, Small Adult, 2- Tube, Twist Lock connector
- 16.9.18 Welch Allyn REUSE-11-2MQ Cuff, Adult, 2-Tube Twist Lock connector

COMPLY: YES___ NO___

16.10 **PROFESSIONAL DEFIBRILLATORS/MONITORS: Worry-Free Service Plan - 5 Years At Time of Sale**
Includes: Annual preventive maintenance, 27% discount on new cables, 27% discount on additional SurePower II Batteries, discount on parameter upgrades, SurePower II Battery replacement upon failure, and accidental damage coverage (see below). Shipping and use of a Service Loaner during repairs, no charge shipping. Extended warranty is a continuation of the One Year Product Limited Warranty.

Battery replacement and accidental damage guidelines can be found in the ExpertCare Service Plan Terms and Conditions on the ZOLL website

COMPLY: YES___ NO___

17.0 OXYGEN, VACUUM SYSTEMS

17.1 **MAIN OXYGEN SUPPLY:** The completed ambulance shall be equipped with a Lift that shall have four UHMW-reinforced straps for securing a **customer-supplied-and-installed** M through H sized oxygen cylinder. The cylinder mount shall be tested and in full compliance with SAE-J3043 requirements. The cylinder and its universal retention components shall be located in the streetside front exterior compartment as specified in 9.3 of this Specification.

The Oxygen System shall also include a 50 PSI, pre-set Oxygen Regulator and an electronically controlled on/off solenoid with manual override located on the action area wall.

The retention bracket shall be positioned so that the cylinder's main valve and regulator are visible through a Polycarbonate viewing window in the forward end of the EMSP Action Area. **COMPLY: YES___ NO___**

17.2 OXYGEN OUTLETS: Two (2) Oxygen outlets shall be provided in the EMSP Action Area panel. The outlet latches shall be Ohio style, quick connects.

One (1) Oxygen outlet shall be located on the wall above the forward section of the squad bench. Outlet latch shall be Ohio style, quick-connect.

One (1) Oxygen outlet shall be located on the ceiling at the rear of the patient compartment. Outlet latch shall be Ohio style, quick-connect. **COMPLY: YES___ NO___**

17.3 OXYGEN HOSES: All oxygen system service hoses, fittings and devices shall be made of non-ferrous materials. Hoses used to pipe Medical Oxygen shall be ¼" inside diameter with an abrasion resistant, green colored, electrically conductive outer jacket. All hoses, connectors and outlets shall withstand a system test pressure of 200 PSI test as prescribed in Federal Specification current KKK-A-1822 requirement 4.4.1 and AMD Standard 015- Ambulance Main Oxygen System Test. Each ambulance shall be tested. "Type Testing/Certification" is not acceptable.

COMPLY: YES___ NO___

17.4 VACUUM (SUCTION) SYSTEM: A 12-Volt DC electric vacuum pump shall be installed in the upper left-hand corner of compartment #2. The system shall meet performance guidelines set forth by Federal Specification KKK-A-1822 requirement 3.12.2 and AMD Standard 021- Aspirator System Test, Primary Patient. A SSCOR vacuum regulator and gauge panel shall be installed in the action area control panel. The vacuum regulator shall control the vacuum pressure delivered to a collection system with a disposable collection canister. The Vacuum gauge shall not be mounted on the collection canister but on the Action Area wall as an integral part of the vacuum control panel and be hard plumbed to the electric vacuum pump. Each ambulance shall be tested. "Type Testing/Certification" is not acceptable.

COMPLY: YES___ NO___

17.5 DIGITAL O2 DISPLAY: Amico, Digital Contents Monitor with Manual By-Pass and switch on A/A panel.

COMPLY: YES___ NO___

17.6 O2 LIFT: O2 Cylinder Mount, Universal Lift Zico QR-OTSL-US for H-Cylinder, LH Drive, LH Remote Control; Mounting Bracket and Can Cover required. Location: Compartment #1. **COMPLY: YES___ NO___**

17.7 O2 BRACKETS: O2 Cylinder Mount, (2) CPI OA1201-D-1 strapless oxygen bottle holder with mounting plate, for (1) "D" cylinder.

Specify Location(s): (1) mounted behind the tech. seat; (1) in comp #2, right hand wall at floor and towards door opening so stairchair can be stored behind at back wall. **COMPLY: YES___ NO___**

18.0 ELECTRICAL SYSTEM – 12VDC

The 12 VDC Electrical system installed in this vehicle must comply with AMD Standard 005- 12-Volt DC Electrical System Test. This electrical System shall be covered under the manufacturer's Warranty for a period of 72 months (6 yrs) or 72,000 miles which ever shall occur first. The electrical system relays, breakers and control modules shall be located on the upper bulkhead wall behind the technician's seat in a cabinet with latching door.

18.1 **BODY GROUNDING:** A minimum of (2) two 1" wide braided ground straps shall be bolted through the chassis frame and the floor structure of the modular body. The bolts shall be 3/8" diameter. A flat washer shall be provided under the head of the bolt, over the strap lug and an internal tooth lock washer shall be installed under the lug to preclude loosening. Chassis frames with asphalt/wax coating or E-coating shall have grounding sites prepared by lightly grinding or sanding the coating away to reveal raw metal.

COMPLY: YES___ NO___

18.2 **GENERAL GROUNDS:** To comply with federal specification current KKK-A-1822 requirement 3.7.12 plus enhance ground quality and reduce trouble shooting time, all devices wired within the ambulance conversion shall be grounded to a ground bar located in the Electrical Cabinet. The ground bar is grounded to the chassis frame by a 2/0 AWG cable and attached in the same manner as the braided body ground cables. Each device shall have a separate ground wire routed to a central buss bar then grounded via fine strand cable to the module body.

COMPLY: YES___ NO___

18.3 **12-VOLT WIRE:** All wires within the ambulance harnesses shall meet Federal Specification current KKK-A-1822 requirement 3.7.2 and 3.7.2.1. All wire insulation shall be GXL cross-linked polyethylene.

Permanent wire identification and wire function shall be stamped on 4" centers along the full length of the wire. Wire conductors shall be stranded copper. Single strand copper conductors are not acceptable due to vibration concerns and stiffness which promotes loosening of the terminals.

COMPLY: YES___ NO___

18.4 **WIRE PROTECTION:** All wire within the conversion shall be protected and run in split convoluted loom with a melting temperature of 300 degrees Fahrenheit. All wire harnesses shall be clamped and routed to eliminate possibility of damage due to cut/chaffed wire. Grommets made of rubber or plastic shall be used where harnesses pass through metal or wood. Large holes and irregular shaped wire passages shall use automotive edge trim to protect the wire conduit/loom. Wire harnesses shall be neatly clamped into protective routing areas away from heat sources, unfriendly edges or moving devices.

COMPLY: YES___ NO___

18.5 **CIRCUIT BREAKERS:** All conversion 12VDC circuits shall be protected by non-proprietary, manual reset, circuit breakers. The trip value for the breaker shall not exceed 80% of the amperage rating of the weakest component in the circuit. Branch circuit wire sizes shall be rated 125% of the expected load per current KKK-A-1822 requirement 3.7.2.1.

COMPLY: YES___ NO___

18.6 **12 VOLT DC OUTLETS:** Three 12 Volt DC, 20 Ampere, cigarette style outlets shall be supplied; one (1) in the action area, one (1) in the ALS Cabinet and (1) one in the 2nd Action Area. Additional Electrical: 12VDC, Receptacle, Cigar style. Location(s): curbside wall over head of bench
Each outlet shall be separately protected and shall be electrically isolated from other electrical functions on the vehicle. The outlets shall be wired per Federal Specification current KKK-A-1822 requirement 3.7.7.3.

COMPLY: YES___ NO___

18.7 **DUAL 2Amp USB OUTLETS:** There shall be a dual Vanner 2 Amp USB charging receptacle mounted next to the 12VDC receptacle on the action area wall.

(2) **Two more dual 2Amp USB outlets:** There shall be a dual Vanner 2 Amp USB charging receptacle mounted next to the 12VDC receptacle. Both on the curb side wall. COMPLY: YES___ NO___

18.8 **USB-C & A:** Dual port USB-C & USB-A power outlet with waterproof cover. Requires drilling round hole. LOCATION: (1) on each vertical side of console, up high. COMPLY: YES___ NO___

18.9 **AS-BUILT ELECTRICAL SCHEMATICS:** Engineering to provide as-built Electrical schematics. COMPLY: YES___ NO___

19.0 ELECTRICAL SYSTEM- 125VAC

19.1 **125 VAC Electrical System** described in this Specification shall comply with AMD Standard 009- 125-Volt AC Electrical Systems Test. This electrical System shall be covered under the manufacturer's Warranty for a period of 72 months (6 yrs) or 72,000 miles which ever shall occur first. COMPLY: YES___ NO___

19.2 **PRIMARY SHORELINE INLET:** 125VAC, 20-Amp, Kussmaul SUPER Auto Eject side wired with hinged, WHITE, weatherproof cover, Located above Compartment #2 on Streetside. Will have to be mounted on a Kussmaul Stainless Steel E-Z mounting plate with green indicator light for ease of access. Mating Connector to be shipped loose.

This inlet shall supply power to all interior 125VAC outlets. The inlet shall be grounded to keep continuity with the G.F.I. breaker in the building in which the vehicle is housed or where it is most frequently connected to shore power. The circuit shall be ground fault and circuit breaker protected incorporating a manual reset switch control (GFI) with a UL approved QO type single phase load center located behind the driver seat in the cab. All 125VAC wiring shall be 12 gauge. All 125VAC AC wiring connections shall be made in UL approved junction boxes. A battery charger pigtail with female plug will be routed to the battery charger prewire area.

A permanent, aluminized vinyl label, stating voltage and amperage shall be located above the inlet in compliance with current KKK-A-1822 requirement 3.7.8, 3.7.8.1. COMPLY: YES___ NO___

19.3 **INVERTER:** Vanner LSC12-1100- 1100watt with 3-Stage 55Amp battery charger, 20Amp power supply and built in GFI. Remote controlled with switch in the rear switch panel.

Fan, Mechantronics Fan, (1) Axial 120x25MM 12VDC ventilation fan mounted on cabinet door or side wall when any inverter is mounted in an interior, enclosed cabinet. COMPLY: YES___ NO___

19.4 **BATTERY CHARGER:** Included with Vanner Inverter LSC12-1100. COMPLY: YES___ NO___

19.5 **125 OUTLET No.1:** A 125VAC, Hospital grade, Straight blade outlet shall be provided on the wall of the main Action Area. The outlet must be grounded and protected by a G.F.I. (Ground Fault Interrupter) Breaker. The outlet must illuminate a green indicator light when power is applied to the outlet. **COMPLY: YES___ NO___**

19.6 **125 OUTLET No. 2:** A 125VAC, Hospital grade, Straight blade outlet shall be provided in the ALS cabinet. The outlet shall be grounded and protected by a G.F.I. (Ground Fault Interrupter) Breaker. The outlet must illuminate a green indicator light when power is applied to the outlet. **COMPLY: YES___ NO___**

19.7 **125 OUTLET No. 3:** A 125VAC, Hospital grade, Straight blade outlet shall be provided in the 2nd Action Area. The outlet shall be grounded and protected by a G.F.I. (Ground Fault Interrupter) Breaker. The outlet must illuminate a green indicator light when power is applied to the outlet. **COMPLY: YES___ NO___**

19.8 **125 OUTLET No. 4:** A 125VAC, Hospital grade, Straight blade outlet shall be provided in the curbside wall over head of bench. The outlet shall be grounded and protected by a G.F.I. (Ground Fault Interrupter) Breaker. The outlet must illuminate a green indicator light when power is applied to the outlet. **COMPLY: YES___ NO___**

19.9 **FUSE BLOCK:** 8AWG - 12VDC ignition, power and ground from battery to a Blue Sea PN: 5032 ST Blade Split Buss "12" Fuse block – Two isolated groups of six circuit fuses with cover for "Battery Hot" and "Ignition Hot" wiring.
NOTE: Mount (1) in lower cabinet "E" and mount (1) behind passengers seat. **COMPLY: YES___ NO___**

20.0 ENVIRONMENTAL

20.1 **REAR AIR CONDITIONING:** The design of the environmental system is to provide optimal air flow and distribution of conditioned air to the module interior. Conditioned air shall be discharged from one vent area and shall be distributed through five vents evenly spaced across the face of the upper section of the ALS cabinet. The module shall have an additional, self-contained A/C evaporator unit complete with dual blower, brushless PWM motor driven, high output fans. The fans shall provide up to seven variable speeds and shall contain a 720 CFM fan. The A/C unit shall also incorporate a hot water heater core for heat. All heater hoses shall be 3/4-inch QVM approved Nomex for improved circulation. Hot water flow shall be controlled by one (1) vacuum actuated inline water valves. All A/C fittings shall be ferruled, banded, or snap ring type.

Spheros "STAND ALONE" High capacity, maximum cool horizontal blow Heat-AC system to include a STAND-ALONE HVAC compressor mounted on the OEM engine by Spheros installers and a roof mounted condenser Spheros PN: 25067. The system shall include a digital thermostat mounted on the action area wall and inline booster pump to enhance the rear heater performance. The evaporator unit will be mounted in the front bulkhead.

NOTE: Requires additional independent AC Compressor mounted on the engine.

The Vehicle A/C – Heater system must meet or exceed federal specification current KKK-A-1822 requirement 3.13.1 thru 3.13.3 and must be compliant with AMD Standards 011- Equipment Temperature Test, 012- Interior Climate Control Test. **COMPLY: YES___ NO___**

20.2 **REAR AC CONTROLS:** The digital thermostat control switch shall be located in the action area. The thermostat shall control the On/Off function, temperature control and fan speed. **COMPLY: YES___ NO___**

20.3 HVAC SYSTEM INSTALLATION:

The auxiliary heating and air conditioning system shall be installed in the ambulance at the ambulance manufacturer's facilities by technicians employed by the manufacturer of the HVAC equipment. Said technicians shall document the installation on forms provided by the HVAC manufacturer and on forms required by the ambulance manufacturer.

COMPLY: YES___ NO___

20.4 **UV-C DISINFECTION LIGHT:** Install a UV-C ADU-160 Disinfection light in ceiling. Will require a special roof-see engineering print. Locate the control module (push button timers) for the light on the right hand wall of the #3 Compartment up high above shelf and close to the door opening, as per prints. All patient area entry doors to be wired to control board so that light does not activate with door open. Wire to operate on 125VAC power from Shoreline Only. Install in ceiling above the cot as per print. Install with EVS Trim pad.

COMPLY: YES___ NO___

20.5 **IV WARMER:** Smithworks, Floor Mount model mounted in cabinet. IV warmer to be powered by inverter or when shoreline is plugged in. Location: Mount in upper rear cabinet A1 on floor, left side. NOTE: Hard wire.

COMPLY: YES___ NO___

21.0 CONSOLES, SWITCH PANELS

21.1 **CAB CONSOLE:** The ambulance conversion control console shall be ergonomically designed, fully formed and welded .125" 5052-H32 aluminum console and adapter to the match the contour of the engine cover. Sharp and other unfriendly edges shall be rounded. The body of the console shall be powder coated with a textured, black finish. The console shall be tested and secured in a manner to meet the requirements of SAE J3043. It shall also provide ease of accessibility for maintenance and service and to minimize engine repair access and time. The console shall include an electronic siren, the driver's switch panel, two cup holder positions, a map pocket and area for mounting radio(s).

Custom removable panels to house Motorola XPR5550E remote radio head (separate option) and Motorola APX8500 remote radio head (separate option). Console to include radio head mounting brackets. Switch Panel cut-out will be sized for special panel in CenCom option below.

COMPLY: YES___ NO___

21.2 A switch panel made from a thick, composite/acrylic sheet shall be installed on the forward end of the floor console. All switches and controls shall have back lighted legends indication function and status. The Switch Panel shall have the following minimum controls and indicators:

- | | |
|---------------------------------------|----------------------------|
| 1. Compartment Open indicator | 8. Rear Flood Switch |
| 2. Battery On indicator | 9. Right Flood Switch |
| 3. Door Open indicator | 10. Back-Up Alarm Switch |
| 4. MASTER Emergency Switch, red bezel | 11. Spare |
| 5. Primary Secondary Mode Switch | 12. Digital Volt/Amp Meter |
| 6. Siren/Horn Switch | |
| 7. Left Flood Switch | |

COMPLY: YES___ NO___

21.3 **SWITCH PANEL, ACTION AREA:** A switch panel made from a thick, composite/acrylic sheet shall be installed on the outboard wall of the Action Area. All switches and controls shall have back lighted legends indication function and status. The Switch Panel shall have the following minimum controls and indicators:

- | | | |
|------------------------------------|---------|------------------|
| 1. Dome Lights, Cot Switch | (Hi/Lo) | 5. Inverter |
| 2. Dome Lights, Bench Switch | (Hi/Lo) | 6. Digital Clock |
| 3. Vacuum System Switch, red bezel | | 7. Spare Switch |
| 4. Exhaust Vent Switch | | 8. Thermostat |

COMPLY: YES___ NO___

21.4 **SWITCH PANEL, CURBSIDE:** Switch Panels: Rear, Eight (8) Switch control panel with two rows of four blanks, available to use with other switch options, IATS. Locate on curbside wall over head of bench per print.

NOTE, switches listed below from other required options.

Top Row: (1) 3-way Left Dome Lights, (1) 3-way Vacuum, (1) 15 Min. Timer, (1) Power Door locks.

Bottom Row: (1) 3-way Right Dome Light, (1) 3-way Vent, (1) blank, (1) blank. COMPLY: YES___ NO___

21.5 **Three (3) WAY SWITCHING:** (2) ON/ON 3-Way power vent switches, switches labeled VENT for the power vent operation. Locate (1) in the existing action area Positron switch panel and (1) in the optional Positron switch panel location on the curbside wall.

COMPLY: YES___ NO___

(2) **ON/ON 3-Way switches** for Suction Operation, located (1) in the existing action area Positron switch panel. Vacuum switch and (1) in the Positron switch panel located on the curbside wall. COMPLY: YES___ NO___

(4) **ON/OFF/ON Momentary switches** - (2) "High / Left Dome / Low and (2) "High / Right / Dome Low to achieve Hi / Low 3-way switching. Locate (2) in the existing action area Positron switch panel and (2) in Positron switch panel location on the curbside wall. Requires (2) 3-way switching modules from Positron. COMPLY: YES___ NO___

21.6 **CONSOLE ARMRESTS:** (1) Set of armrests for Type I Aluminum Console. Havis Shields C-ARM-102 adjustable armrests, (1) mounted each side of console.

COMPLY: YES___ NO___

22.0 VISUAL CONSPICUITY - EXTERIOR LIGHTING

22.1 **WARNING LIGHTS:** The warning light system shall meet or exceed current KKK-A-1822 requirements as demonstrated with the documentation provided by the lighting manufacturer.

The warning lights shall be configured like, and flash in compliance with, current KKK-A-1822 requirement 3.8.2.1, and Table 1.

COMPLY: YES___ NO___

22.2 **DUAL MODE FLASHERS:** A dual mode Primary/Secondary flasher shall be provided for the vehicle emergency warning light system as required in KKK-A-1822. Customer would like front and rear lights to operate in X flash pattern. Secondary Mode to have Grille, Intersection and forward facing clear lights to deactivate. Lights shall be configured as depicted in the attached drawings and as described below:

COMPLY: YES___ NO___

22.2.1 **FRONT WALL:** The front wall shall be configured with seven Whelen M9 Series LED warning lights mounted on the front of the body. These LED lights shall be configured BLUE/RED/WHITE/RED/WHITE/RED/BLUE along the upper

edge of the front wall. These lights shall be wired to flash in primary/secondary modes or as required by the purchaser. The lenses shall be clear.

COMPLY: YES___ NO___

22.2.2 WARNING LIGHTS- DRIVER SIDE: There shall be (2) Whelen M9 Series Red LED warning lights mounted on the driver side of the module. (1) In the upper forward and (1) in the upper rearward corners of the module. The lenses shall be clear.

COMPLY: YES___ NO___

22.2.3 WARNING LIGHTS- PASSENGER SIDE: There shall be (2) Whelen M9 Series Red LED warning lights mounted on the passenger side of the module. (1) In the upper forward and (1) in the upper rearward corners of the module. The lenses shall be clear.

COMPLY: YES___ NO___

22.2.4 WARNING LIGHTS- REAR: The ambulance shall be equipped with (2) Whelen M9 Series BLUE LED warning lights positioned on the upper outboard module corners and (1) Whelen M9 Series amber LED centered above the rear doors on the rear wall. The LED's shall be configured as follows: BLUE/Amber/BLUE. The lenses shall be clear.

COMPLY: YES___ NO___

22.2.5 REAR MID-BODY WARNING LIGHTS: This unit shall be equipped with (2) Whelen M9 Series Red LED warning lights mounted on the rear of the module set to show through the rear door windows when the rear doors are open. These LED lights shall be wired to function as brake lights when not in emergency mode. The lenses shall be clear.

COMPLY: YES___ NO___

22.2.6 GRILLE LIGHTS: This unit shall be equipped with (2) Whelen LINZ6R Series Red Super LED warning lights mounted on the upper and (2) Whelen LINZ6B Series BLUE Super LED warning lights mounted on the lower chrome cross bar of the OEM grille in compliance with the OEM chassis manufacturer's guidelines and the lighting requirements of KKK-A-1822F. These LEDs shall function in the primary mode only. The lenses shall be clear.

COMPLY: YES___ NO___

22.2.7 INTERSECTION LIGHTS – CAB: This unit shall be equipped with (4) Whelen M7 Series Red LED warning lights mounted in the forward area of the chassis front fenders and rear over wheel wells in compliance with the OEM chassis manufacturer's guidelines and the lighting requirements of KKK-A-1822F. These warning lights shall function in the primary mode only. The lenses shall be clear.

COMPLY: YES___ NO___

22.3 TAILLIGHTS: Taillight configuration shall be Whelen M6 Series LED Tail/Brake, Turn Signals and Back-up Lights installed w/ chromed bezels. These lights shall be stacked vertically above the diamond plate rear kick plate in the order presented above.

COMPLY: YES___ NO___

22.4 I.C.C. LIGHTS: 3/4" round LED clearance lights shall be provided per FMVSS and D.O.T. Standards. The lights shall indicate the height and width of the vehicle and define the vehicle centerline. These lights will be mounted on the uppermost margins of the front and rear body. The lights shall be mounted in rubber grommets and the mounting location for each light shall be prepared prior to the paint process to reduce the possibility of paint break and resulting corrosion. Drilling or tapping through a painted body shall not be acceptable. There shall be five (5) amber clearance lights (TecNiq LED model S34-AC09-1) forward facing and five (5) red clearance lights (TecNiq LED model S34-RC09-1)

rear facing. Additionally, there shall be two (2) matching amber D.O.T. marker/directional lights mounted one (1) each side of the module on the rear corner extrusions and two (2) matching red D.O.T. marker lights mounted one (1) each side of the module on the rear corner extrusions. The D.O.T. marker lights shall be located approximately 48" above ground level.

COMPLY: YES ___ NO ___

22.5 LICENSE PLATE LIGHT: The license plate holder shall be a cast aluminum housing that is near flush mounted on the rear of the module. The housing shall be mounted in the lower diamond plate kick panel below the street side B/T/T lighting. There shall be two (2) LED lights installed to provide illumination to the license plate with the chassis park light circuit on.

COMPLY: YES ___ NO ___

22.6 SCENE LIGHTS: Two Whelen M scene lights shall be provided on each side of the module. The curbside lights shall come on when the curbside entry door is opened.

The streetside and curbside scene lights may be turned ON/OFF with (2) two separate, right and left scene rocker switches located on the cab console switch panel. There will be a momentary disconnect switch located at the side entry door for disabling the scene lights during the daylight hours.

COMPLY: YES ___ NO ___

22.7 LOAD LIGHTS: Two Whelen M scene load lights shall illuminate the rear of the module. Both rear lights shall come on with the opening of the leading rear access door. These rear load lights will also activate when the vehicle transmission is placed in reverse or when the rear load switch in the cab console switch panel is activated. There will be a momentary disconnect switch located on the wall at the curb side rear entry door for disabling the load lights during the daylight hours.

COMPLY: YES ___ NO ___

22.8 PERIMETER LIGHTING CERTIFICATION: To assure that the exterior work lighting is adequate to perform EMS functions in a variety of settings which may require exterior illumination, the Scene and Load lights installed on this vehicle shall comply with AMD Standard 024- Perimeter Illumination Test.

COMPLY: YES ___ NO ___

22.9 COMPARTMENT LIGHTING: The compartments shall be illuminated with TecNiq flexible LED Compartment lights. The lights shall function each time the compartment door is opened and extinguish when the door is closed. The lights shall be located: (1) Compartment #1; (2) in Compartment #2 (2) Compartment #3; (1) in Compartment #4/5; (2) in Compartment #6; (1) in Compartment #7.

COMPLY: YES ___ NO ___

22.10 TURN ARROW LIGHTS: There shall be two sets of Whelen M6TC Amber LED turn arrow lights; one set placed on the front wall below the outboard warning lights and one set placed on rear wall between mid-body lights and lower tail lights.

COMPLY: YES ___ NO ___

23.0 AUDIBLE CONSPICUITY

23.1 ELECTRONIC SIREN: The siren shall be a Whelen Emergency, CenCom Core System used for Vehicle-to-Vehicle syncing, Front Switch Panel, Siren & Vanner Flasher. This system allows the customer's vehicles to match other vehicles' emergency warning systems in their fleet. The control head will contain functions for Emergency Master, Primary/Secondary Modes, Siren/Horn, Left, Rear and Right Floods, Back-Up Alarm, Module Disconnect and Dual Tone Siren.

-Switch Panel: Requires special panel with no standard switch cut-outs or siren cut-out in order to mount the CenCom Control Head. It will include a standard voltmeter and code lights.

-Whelen CenCom Core system will include:

(1) Control Module (C399)-located in the electrical cabinet.

(1) OBDII Canport kit for Ford/Dodge (C399K1)-ran to under dash for possible future usage-will not be connected.

(1) WCX 16 Output expansion modules (CEM16).

(1) WCX Vehicle-to-Vehicle Sync Module (CV2V).

(1) CCTL6 Knob/Slide Control Head-mounted on switch panel in blank area where switches were located.

(2) Mics with Extension Cables-Cables will be ran from the control center in the electrical cabinet to the front console where the Mics are located.

The siren speakers shall be dual Cast Products 100-watt drivers and shall emit selected tones through cast aluminum speakers located through the grille. The siren speakers shall not block airflow into the grille per the OEM chassis manufacturer's guidelines. The siren and speakers shall meet or exceed current KKK-A-1822 requirement 3.14.4 and be compliant with AMD Standard 023- Siren Performance Test and AMD Standard 006- Patient Compartment Sound Level Test.

COMPLY: YES___ NO___

23.2 BACK UP ALARM: The vehicle shall include a minimum 97 decibel back up alarm device. The alarm shall be automatically activated by shifting the vehicle transmission into reverse. The backup alarm shall include a rocker type momentary cut-off switch located in the cab console Switch Panel. The alarm device shall be provided as required in current KKK-A-1822 requirement 3.15.2 and shall be compliant with SAE Standard J994. **COMPLY: YES___ NO___**

24.0 INTERIOR LIGHTING

24.1 ACTION AREA LIGHTING: TecNiq dimmable red/white LED installed. Does not require the standard On/Off switch on rear control panel.

COMPLY: YES___ NO___

24.2 STEPWELL ILLUMINATION: A 12 VDC LED light shall illuminate the curbside stepwell per Federal Specification current KKK-A-1822 requirement 3.10.12. This light shall be activated only when the curbside entry door is open.

COMPLY: YES___ NO___

24.3 PATIENT COMPARTMENT DOME LIGHTS: The patient compartment shall have ten (10) dual intensity Whelen 8" round LED dome lights in the ceiling. The domes centers shall be installed in two (2) light banks with (5) streetside overhead and (5) curbside overhead. Each bank of lights shall be individually controlled Hi/Off/Low and the configuration shall meet current KKK-A-1822 requirements 3.8.4, 3.8.4.1 and be compliant with AMD Standard 016- Patient Compartment Lighting Level Test.

COMPLY: YES___ NO___

24.4 CABINET LIGHTING: TecNiq Oval Dragon, Blue, with SS case, 36" wire with switch labeled "Cabinet Lights" in rear switch panel.

Location: (2) in A1, (2) in A2, (2) in action area overhead, (1) in each squad bench overhead section.

COMPLY: YES___ NO___

24.5 SPOTLIGHT: 300,000 CP handheld, hard wired, with momentary On/Off switch, located in cab.

COMPLY: YES ____ NO ____

24.6 **CHECK-OUT TIMER:** A 5-minute check-out timer shall activate by opening the rear or side entry door when the battery switch is off. The curbside bank of dome lights shall turn on in the "high" mode. Following the first 5-minute cycle the lights will deactivate. The cycle can be reactivated by closing, then re-opening the side or rear entry door.

COMPLY: YES ____ NO ____

24.7 **SWITCHING:** Timer, Momentary 15-Minute timer switch for patient compartment dome lights. Locate switch in Positron switch panel in standard position on curbside wall.

COMPLY: YES ____ NO ____

25.0 COMMUNICATIONS EQUIPMENT

25.1 **COMMUNICATIONS RADIO ANTENNA COAX:** RG58-U coaxial cables shall be supplied. (2) 25' Coax with 3/8" through-hole antenna bases prewired to roof ILOS standard coaxial cables. NOTE: Drill hole and complete mount. Terminate coax with standard Power/Ground for each in lower cabinet "E". Run coaxes to above domes #3 and #5 due to the rooftop condenser.

NOTE: Coax ends in cabinet "E" to have 8' service loops.

NOTE: LABEL EACH END OF EACH COAX CABLE

Electrical: Antenna, (1) 25' Coax with 3/8" through-hole antenna base installed/prewired to roof IATS standard coaxial cables; NOTE: Drill hole and complete mount.

-Run (1) coax from above Dome #2 to front console with Power/Ground in front console.

-Run (1) coax from above Dome #4 to lower cabinet "E" with Power/Ground.

NOTE: Coax ends in cabinet "E", front console and under hood to have 8' service loops.

NOTE: LABEL EACH END OF EACH COAX CABLE.

COMPLY: YES ____ NO ____

25.2 **RADIO EQUIPMENT:** Radio/Repeater Equipment, purchased and installed by bidder. Radios and Pyramid Repeater SVR250 with 7508-10-1247 SVR250 Interface Cable

-Will be programmed by customer after delivery. Customer specific radio quote, includes:

1. One (1) Motorola APX8500 100-watt radio with
 2. PMMN4097C Mobile Microphone for APX w/BT gateway
 3. Two (2) E5 control heads. One remote head will be installed in the front console in the rear most removable panel and one remote head will be installed in the patient area using the provided U-bracket, hanging from the action area overhead, left hand side.
 4. Run the 30' Motorola cable from front console to lower cabinet "E".
-
1. Description: Pyramid SVR250 Repeater with 7508-10-1247 SVR250 Interface Cable to Motorola APX-8500, RF jumper from repeater to pre-selector controller and notch filter shall be provided and installed by manufacturer.
 2. Parts requested –
 3. (1) Pyramid SVR-250 Vehicular Repeater
 4. (1) 7508-10-1247 (Motorola APX-8500 Mid/Low/High Power) Pyramid SVR 250 Smart Cable

5. (1) Pyramid Pre-selector for Pyramid SVR250

- Location: Repeater in Cabinet E, antenna with trunk groove bracket near chassis hood, curbside.

Additional Instructions: All connections shall be made, and the #BRF-1601 notch filter shall be installed between the Motorola APX8500 transceiver and the Larsen NMO150C VHF antenna on the module roof. The #BPF-1604 pre-selector filter shall be installed between the Pyramid repeater and the Larsen NMOQB VHF quarter wave with trunk groove bracket on the chassis hood

NOTE: Additional components such as speakers and microphones will be installed by bidder prior to customer's final inspection. Main radio and other components will be located in lower cabinet "E". Customer shall be responsible for powering up and tuning any radio equipment.

***Antenna location notes for install:

-AirGainConnect Fleet antenna and 3-in-1 Wi-Fi antenna will both be located above the action area overhead and terminate in lower cabinet "E".

-8-in-1 antenna will be located above the electrical cabinet and terminate in lower cabinet "E".

-Motorola AN000163A01 will be located over compartment #1 and terminate in the lower cabinet "E".

***NOTE: LABEL ENDS OF EACH CABLE.

COMPLY: YES___ NO___

25.3 **ANTENNA:** Set of (3) radio antennas - to be installed by bidder.

-(1) AirGainConnect Fleet - 5G Integrated Modem, White: 1GbE RJ45 LAN connection, 2xWi-Fi, 2xMU-MIMO, with 30' CAT6 cable.

-(1) 8-in-1 Dome Antenna - 4x5G/4G, GNSS, 3xWi-Fi, 2.4/5GHz, Bolt Mount, White with eight 30' cables.

-(1) 3-in-1 Wi-Fi Antenna - 3xWi-Fi, 2.4/5GHz, Bolt Mount, White with three 30' cables.

-(1) Motorola AN000163A01 WIFI/GNSS Low Loss Stubby Antenna.

See Radio option above for locations.

COMPLY: YES___ NO___

25.4 The Bidder/Vehicle Manufacturer will deliver the ambulances to Electronic Center, 812 S. Boardman Drive, Gallup, New Mexico 87301.

COMPLY: YES___ NO___

26.0 PAINT, LETTERING, DECALS, MISCELLANEOUS

26.1 **100% PAINTFILM COVERAGE:** All stages of primer and paint shall cover all weather-exposed surfaces. Hinge mating surfaces on the doors and jambs shall be painted. Bare aluminum and primer-only preparation is not acceptable under door hinges. Doors shall be painted without actuation handles installed. All body cutouts for emergency lighting, shoreline receptacle, etc., shall be cut prior to initiating the prime/paint process to assure complete coverage of all exposed, raw metal.

All the module entry and compartment doors shall be removed prior to painting and be painted separately, at the same time and identically to the module process to ensure complete coverage and electrolysis protection between the stainless-steel hinge and the aluminum door and frame surfaces.

To reduce the risk of breaking paint and to provide for a more consistently robust paint application, all light holes, the license plate bracket hole, gas filler bracket hole, all door window and handle holes and exhaust fan and any other option required mounting holes shall be cut in the module prior to beginning the paint process. Intersection light holes shall be cut in the chassis fenders and cut out must be coated with a corrosion resistant material to comply with Ford QVM requirements to prevent oxidation and rusting of the OEM metal surface.

The manufacturer's standard paint process shall provide that all surface body welds and imperfections be ground flush and body filled as needed to provide a smooth even surface that facilitates a flat smooth paint finish.

The entire exterior surface of the module shall be sanded with an air powered DA sander and a minimum 150 grit sandpaper and then the module shall be washed with DX-330 cleaner/degreaser to remove any metal, oil or contaminant residue prior to the application of the seam seal process.

All exterior body seams shall be sealed with 3M panel bond/seam sealer to provide a smooth application environment for the prime and paint processes and to prevent future contamination, oxidation, and corrosion.

The entire exterior surface of the module shall be coated with a primary coat of PPG "Delfleet" etch-coat primer, flash dried and then coated with a high-performance PPG "Delfleet" primer sealer and baked to dry. The primer sealer coat shall be sanded to a flat smooth finish to eliminate all nibs and imperfections, inspected and etch primer/sealer applied where necessary and washed with DX330 to provide a clean, smooth surface prior to the application of the base coat application.

The entire exterior surface of the module shall be coated with an application of PPG "Delfleet" color mixed base coat. The base coat shall be baked to dry and inspected for imperfections. Minor surface repairs shall be utilized to provide a smooth surface prior to the application of the clear coat material. The entire exterior surface of the module shall be coated with an application of a PPG - "Delfleet" clear coat finish that will provide a robust, durable finish. The clear coat finish shall be baked per PPG "Delfleet" process instructions prior to the finished surface process application.

After the clear coat process is completed, the entire exterior surface of the module shall then be sanded with a minimum 1200 grit sandpaper and then buffed using 3M Perfect-It III buffing compound to provide a clean, high gloss final surface finish.

Without exception, the manufacturer shall monitor the entire application process. The inspection process shall provide mil-thickness measurements at numerous random locations across the body to ensure that the total paint process shall provide a minimum of 5 mils dry build, without runs or sags, after the completion of the final sand and buff process.

COMPLY: YES___ NO___

26.2 PAINT AND COLORS: The module shall be painted to match chassis. Any painting performed by the manufacturer, of the body and/or chassis, shall be covered under warranty for a period of not less than four (4) years / forty-eight (48) months, and shall be sanctioned by the paint manufacturer.

NOTE: PPG WILL HANDLE TOUCH-UP PAINT DELIVERY TO CUSTOMER, AFTER FINAL INSPECTION/DELIVERY.

COMPLY: YES ____ NO ____

26.3 LETTERING & DECALS:

The lettering and graphics kit shall be applied per customer specifications.

The vehicle manufacturer will coordinate with:

Kings of Wrap LLC

4021 Barbara Loop SE, Rio Rancho NM. 87124

Primary Contact:

Raul Rodriguez, (Owner)

Office: 505.892.1983. E:

The Bidder/Vehicle Manufacturer will deliver the EMS Rescue Units to King Wrap LLC.

Address: 4021 Barbara Loop SE, Rio Rancho NM 87124, for installation of graphics kit.

COMPLY: YES ____ NO ____

The following labels shall be provided as standard.

'Notice: This vehicle Equipped with 12VDC charging System (Mounted in cab)'

'Shore Inlet 125VAC 60 Hz'

'125VAC Outlet'

'12VDC Outlet'

'Diesel Only' or 'Gasoline Only' (per chassis requirements)

'No Smoking/Oxygen Equipped'

(2) 'Fasten Seat Belt' signs provided: (1) located in the cab and (1) in the module. COMPLY: YES ____ NO ____

26.4 SHIP LOOSE EQUIPMENT:

1. Antennas, set of (3) radio antennas. (1) Larsen NMO150C VHF/UHF Mobile Antenna. (1) Larsen NMOWB450C UHF Wide Band 450-470MHz Mobile Antenna 35 1/2" w/Spring Base. (1) Larsen NM0QB VHF Mobile antenna.
2. Sharps: (25) SHARPS Container, Kendall 8920SA, 2-Gallon with rotor lid.
3. Waste: (10) Waste Container, Beige Wastebasket, PN 66-151009, 2-Gallon.
4. Seat Belt: (3) Automotive Style, (1) 2"W x 45"L female strap.
5. Mirrors, OEM: (1) on interior windshield -SHIP LOOSE DUE TO ASA CAMERA. COMPLY: YES ____ NO ____

27 QUALITY ASSURANCE PROVISION REQUIREMENTS

27.01 QUALITY CONTROL:

Defective components shall not be furnished. Parts, equipment, and assemblies, which have been repaired or modified to overcome deficiencies shall not be furnished without the written approval of Navajo Nation Emergency Medical Service. Construction methods utilized shall be in accordance with industry standards. Component parts and units shall be manufactured to definite standard dimensions with proper fits, clearances and uniformity. The general appearance of the vehicle shall not show any evidence of poor workmanship.

At the time of delivery, the manufacturer's representative shall explain the use and operation of the new vehicle(s) and provide an owner's manual for each of the complete vehicle. The manual shall contain useful information on routine maintenance and trouble shooting. All warranty registration materials shall be completed and explained at the time of delivery. The manufacturer shall arrange for delivery. The vehicle(s) shall be delivered clean and free of road debris with 100 percent fuel on board.

The bidder shall be responsible for the performance and test requirements required herein. Navajo Nation Emergency Medical Service reserves the right to perform any of the inspections and tests set forth in these specifications where such inspections are deemed necessary to assure conformation of specification. The primary manufacturer shall conform to Navajo Nation Emergency Medical Service representatives with instruments and all such assistance as may be required.

COMPLY: YES___ NO___

28 REFERENCES AND STANDARDS

28.1 MANUALS

An Owner's Manual copied onto a CD along with the OEM chassis manufacturers' supplied items shall be provided with each vehicle. The information on the disc and in the Manual content package shall consist of the following items:

1. Chassis Warranty Card & Owner's Information
2. Chassis Maintenance and Operating Tips
3. Extra Set of Keys
4. Lifetime Module Warranty
5. 1 Year/12,000 mile Conversion Warranty
6. 6 Year/72,000 mile Electrical Warranty
7. 4 Year Paint Warranty
8. Care and Maintenance Instruction
9. Heater/AC Information & Warranty
10. OEM Chassis Manual
11. Schematics for Standard Systems:
 - Charging System
 - Power Distribution
 - Front Switch Panel
 - Rear Switch Panel
 - Climate Control System
 - OEM Drawings
 - Wire Harness list
 - Circuit Diagrams for all Systems
12. Conversion Component Information
13. Operations Manual
14. Warranty and Parts List - Siren, Light bar, Etc.

COMPLY: YES___ NO___

27.2 VEHICLE DRAWINGS

The following drawing views shall be provided:

1. Street side Exterior Detail
2. Curbside Exterior Detail
3. Front & Rear Exterior Detail
4. Street side Interior Detail
5. Curbside Interior Detail
6. Front & Rear Interior Detail
7. Overhead Floor Detail
8. Overhead Ceiling Detail

COMPLY: YES____ NO____

29.0 EXCEPTION REQUIREMENTS

29.01 Exceptions shall be submitted as set forth in this document. Navajo Nation Emergency Medical Service will accept proposals from any business entity proclaiming to manufacture vehicle(s) to conform to this specification. Further, Navajo Nation Emergency Medical Service will not deny the right of any manufacturer to present their product.

Bidder must underline in red ink any portion of the section which will not be provided as specified. All exceptions must be fully explained on a separate page, giving reference to the page number and the section where the exception is being taken. Sufficient explanations and documentation shall be provided so that Navajo Nation Emergency Medical Service may evaluate exception.

However, it should be noted, that any primary manufacturer that does not take exceptions shall produce the vehicle exactly as described. Failure to produce said vehicle may be grounds for Navajo Nation Emergency Medical Service to pursue a resolution of damages through legal action.

COMPLY: YES____ NO____

Sheet
A[illegible]

COMPARTMENT SIZES				NOTE: THE DIMENSIONS BELOW ARE ROUGH OPENINGS, SUBTRACT 1/4" FOR TUB SIZE		
NO.	COMPARTMENT TYPE	WIDTH	HEIGHT		DEPTH	
4	A/S / BATTERY COMPARTMENT	---	---		---	
6	BACKBOARD STORAGE COMPARTMENT	12 7/8"	77 3/4"		19"	
7	STORAGE COMPARTMENT	23 3/4"	24 1/4"		15 1/2"	
COMPARTMENT / ENTRY DOOR SIZES						
NO.	COMPARTMENT / ENTRY DOOR TYPE	WIDTH	HEIGHT			
4	A/S / BATTERY COMPARTMENT DOOR	18"	62 1/4"			
6	BACKBOARD COMPARTMENT DOOR	11 3/4"	76 3/4"			
SE	SIDE ENTRY DOOR	28 3/4"	73 1/4"			
7	STORAGE COMPARTMENT DOOR	22 3/4"	23 1/4"			

Note: Drawings are for reference only, measurements may vary from actual product.

ALL COMPARTMENT/ENTRY DOORS TO HAVE POWER LOCKS
WIRE TO OEM

ALL GREEN DIMENSIONS ARE TAKEN FROM EDGE OF WALL
SURFACE PRIOR TO CORNER CAP BEING APPLIED

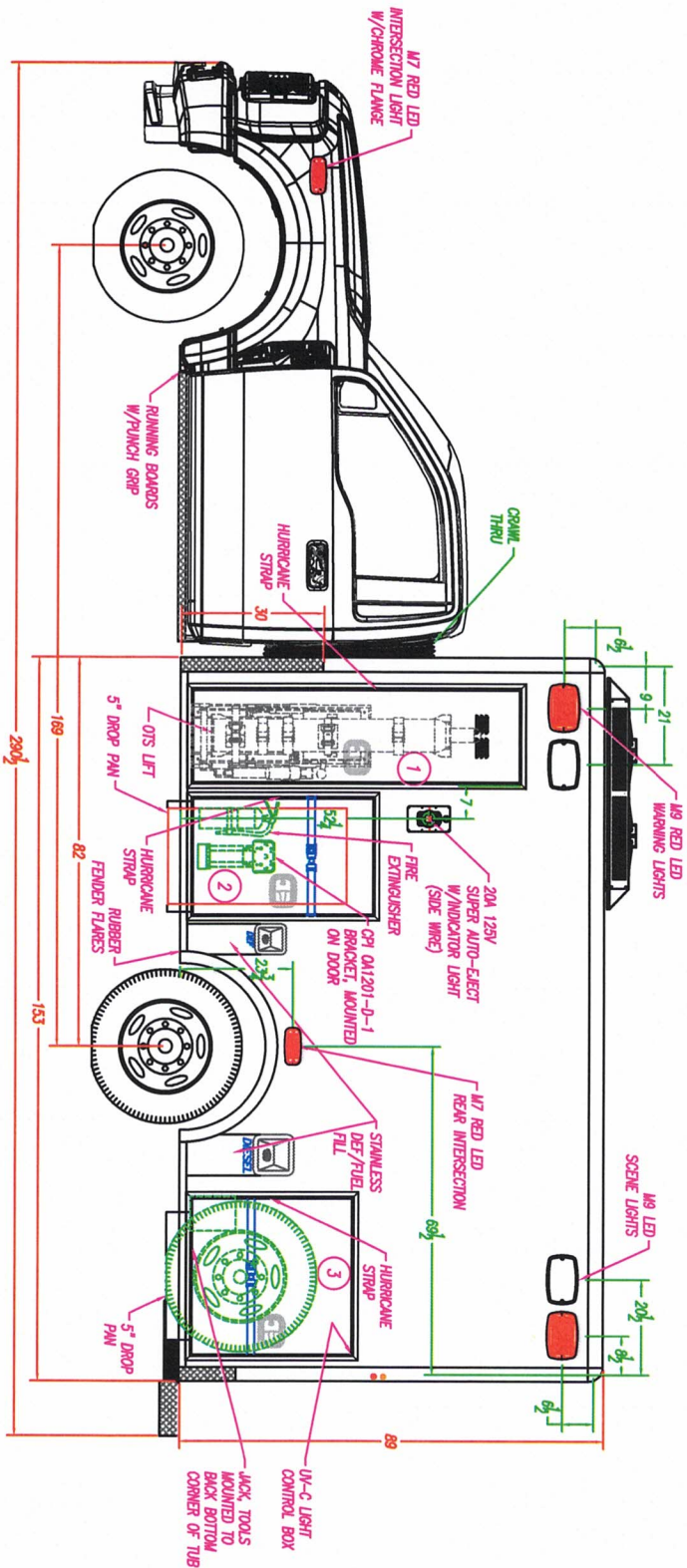

COMPARTMENT SIZES

NOTE: THE DIMENSIONS BELOW ARE ROUGH
OPENINGS, SUBTRACT 1/4\"

NO.	COMPARTMENT TYPE	WIDTH	HEIGHT	DEPTH
1	O2 STORAGE COMPARTMENT	20 3/4"	69 3/4"	15 3/4"
2	MID BODY STORAGE COMPARTMENT	25 3/4"	39"	13 1/4"
3	REAR STORAGE COMPARTMENT	34 1/2"	34 1/2"	18 1/4"

COMPARTMENT / ENTRY DOOR SIZES

NO.	COMPARTMENT / ENTRY DOOR TYPE	WIDTH	HEIGHT
1	O2 STORAGE COMPARTMENT DOOR	19 3/4"	68 3/4"
2	MID BODY STORAGE COMPARTMENT DOOR	24 1/4"	37 1/4"
3	REAR STORAGE COMPARTMENT DOOR	33 3/4"	33 3/4"

FORD F-450 169" W.B.
ME-153"-72" H.R. TYPE I AMBULANCE
DESCRIPTION: STREET SIDE EXTERIOR

SCALE: 5/16"=1'
REVISION: F

Note: Drawings are for reference only, measurements may vary from actual product.

The top drawing is a side profile of the Ford Taurus light bar assembly. It shows the following components and dimensions:

- Dimensions:** Total length 93, wheelbase 89, front overhang 18 1/2, front overhang to first light 8, distance between first and second light 9, distance between second and third light 21, distance between third and fourth light 33, distance between fourth and fifth light 45, distance between fifth and sixth light 21, and distance between sixth and seventh light 9.
- Light Configuration:** (1) Wheel M8 Red LED Warning Lights, (2) Wheel M9 Blue LED Warning Lights, Amber LED Clearance Lights, (3) Wheel M8 Red LED Warning Lights, (4) Wheel M9 Blue LED Warning Lights, (5) Wheel M8 Red LED Warning Lights, (6) Wheel M9 Blue LED Warning Lights, (7) Wheel M8 Red LED Warning Lights, (8) Wheel M9 Blue LED Warning Lights.
- Other Components:** Siren Speakers Behind Grille, Stealth Switch, (2) Lanza Red LED Warning Lights, (2) Lanza Blue LED Warning Lights, Wheel M8 LED Turn Arrows.

The bottom drawing is a top-down view of the rear of the vehicle showing the light bar and mirror mounting. It includes the following details:

- Dimensions:** Total width 89, mirror mounting width 21, mirror mounting to first light 6, distance between first and second light 17 1/2, distance between second and third light 10 1/2, distance between third and fourth light 29, distance between fourth and fifth light 45, distance between fifth and sixth light 29, distance between sixth and seventh light 10 1/2, distance between seventh and eighth light 45, distance between eighth and ninth light 29, distance between ninth and tenth light 10 1/2, distance between tenth and eleventh light 45, distance between eleventh and twelfth light 29, distance between twelfth and thirteenth light 10 1/2, distance between thirteenth and fourteenth light 45, distance between fourteenth and fifteenth light 29, distance between fifteenth and sixteenth light 10 1/2, distance between sixteenth and seventeenth light 45, distance between seventeenth and eighteenth light 29, distance between eighteenth and nineteenth light 10 1/2, distance between nineteenth and twentieth light 45, distance between twentieth and twenty-first light 29, distance between twenty-first and twenty-second light 10 1/2, distance between twenty-second and twenty-third light 45, distance between twenty-third and twenty-fourth light 29, distance between twenty-fourth and twenty-fifth light 10 1/2, distance between twenty-fifth and twenty-sixth light 45, distance between twenty-sixth and twenty-seventh light 29, distance between twenty-seventh and twenty-eighth light 10 1/2, distance between twenty-eighth and twenty-ninth light 45, distance between twenty-ninth and thirtieth light 29, distance between thirtieth and thirty-first light 10 1/2, distance between thirty-first and thirty-second light 45, distance between thirty-second and thirty-third light 29, distance between thirty-third and thirty-fourth light 10 1/2, distance between thirty-fourth and thirty-fifth light 45, distance between thirty-fifth and thirty-sixth light 29, distance between thirty-sixth and thirty-seventh light 10 1/2, distance between thirty-seventh and thirty-eighth light 45, distance between thirty-eighth and thirty-ninth light 29, distance between thirty-ninth and fortieth light 10 1/2, distance between fortieth and forty-first light 45, distance between forty-first and forty-second light 29, distance between forty-second and forty-third light 10 1/2, distance between forty-third and forty-fourth light 45, distance between forty-fourth and forty-fifth light 29, distance between forty-fifth and forty-sixth light 10 1/2, distance between forty-sixth and forty-seventh light 45, distance between forty-seventh and forty-eighth light 29, distance between forty-eighth and forty-ninth light 10 1/2, distance between forty-ninth and fiftieth light 45, distance between fiftieth and fifty-first light 29, distance between fifty-first and fifty-second light 10 1/2, distance between fifty-second and fifty-third light 45, distance between fifty-third and fifty-fourth light 29, distance between fifty-fourth and fifty-fifth light 10 1/2, distance between fifty-fifth and fifty-sixth light 45, distance between fifty-sixth and fifty-seventh light 29, distance between fifty-seventh and fifty-eighth light 10 1/2, distance between fifty-eighth and fifty-ninth light 45, distance between fifty-ninth and sixtieth light 29, distance between sixtieth and sixty-first light 10 1/2, distance between sixty-first and sixty-second light 45, distance between sixty-second and sixty-third light 29, distance between sixty-third and sixty-fourth light 10 1/2, distance between sixty-fourth and sixty-fifth light 45, distance between sixty-fifth and sixty-sixth light 29, distance between sixty-sixth and sixty-seventh light 10 1/2, distance between sixty-seventh and sixty-eighth light 45, distance between sixty-eighth and sixty-ninth light 29, distance between sixty-ninth and seventieth light 10 1/2, distance between seventieth and seventy-first light 45, distance between seventy-first and seventy-second light 29, distance between seventy-second and seventy-third light 10 1/2, distance between seventy-third and seventy-fourth light 45, distance between seventy-fourth and seventy-fifth light 29, distance between seventy-fifth and seventy-sixth light 10 1/2, distance between seventy-sixth and seventy-seventh light 45, distance between seventy-seventh and seventy-eighth light 29, distance between seventy-eighth and seventy-ninth light 10 1/2, distance between seventy-ninth and eightieth light 45, distance between eightieth and eighty-first light 29, distance between eighty-first and eighty-second light 10 1/2, distance between eighty-second and eighty-third light 45, distance between eighty-third and eighty-fourth light 29, distance between eighty-fourth and eighty-fifth light 10 1/2, distance between eighty-fifth and eighty-sixth light 45, distance between eighty-sixth and eighty-seventh light 29, distance between eighty-seventh and eighty-eighth light 10 1/2, distance between eighty-eighth and eighty-ninth light 45, distance between eighty-ninth and ninety light 29, distance between ninety and ninety-first light 10 1/2, distance between ninety-first and ninety-second light 45, distance between ninety-second and ninety-third light 29, distance between ninety-third and ninety-fourth light 10 1/2, distance between ninety-fourth and ninety-fifth light 45, distance between ninety-fifth and ninety-sixth light 29, distance between ninety-sixth and ninety-seventh light 10 1/2, distance between ninety-seventh and ninety-eighth light 45, distance between ninety-eighth and ninety-ninth light 29, distance between ninety-ninth and one hundred light 10 1/2, distance between one hundred and one hundred and one light 45, distance between one hundred and one hundred and two light 29, distance between one hundred and two and one hundred and three light 10 1/2, distance between one hundred and three and one hundred and four light 45, distance between one hundred and four and one hundred and five light 29, distance between one hundred and five and one hundred and six light 10 1/2, distance between one hundred and six and one hundred and seven light 45, distance between one hundred and seven and one hundred and eight light 29, distance between one hundred and eight and one hundred and nine light 10 1/2, distance between one hundred and nine and one hundred and ten light 45, distance between one hundred and ten and one hundred and eleven light 29, distance between one hundred and eleven and one hundred and twelve light 10 1/2, distance between one hundred and twelve and one hundred and thirteen light 45, distance between one hundred and thirteen and one hundred and fourteen light 29, distance between one hundred and fourteen and one hundred and fifteen light 10 1/2, distance between one hundred and fifteen and one hundred and sixteen light 45, distance between one hundred and sixteen and one hundred and seventeen light 29, distance between one hundred and seventeen and one hundred and eighteen light 10 1/2, distance between one hundred and eighteen and one hundred and nineteen light 45, distance between one hundred and nineteen and one hundred and twenty light 29, distance between one hundred and twenty and one hundred and twenty-one light 10 1/2, distance between one hundred and twenty-one and one hundred and twenty-two light 45, distance between one hundred and twenty-two and one hundred and twenty-three light 29, distance between one hundred and twenty-three and one hundred and twenty-four light 10 1/2, distance between one hundred and twenty-four and one hundred and twenty-five light 45, distance between one hundred and twenty-five and one hundred and twenty-six light 29, distance between one hundred and twenty-six and one hundred and twenty-seven light 10 1/2, distance between one hundred and twenty-seven and one hundred and twenty-eight light 45, distance between one hundred and twenty-eight and one hundred and twenty-nine light 29, distance between one hundred and twenty-nine and one hundred and thirty light 10 1/2, distance between one hundred and thirty and one hundred and thirty-one light 45, distance between one hundred and thirty-one and one hundred and thirty-two light 29, distance between one hundred and thirty-two and one hundred and thirty-three light 10 1/2, distance between one hundred and thirty-three and one hundred and thirty-four light 45, distance between one hundred and thirty-four and one hundred and thirty-five light 29, distance between one hundred and thirty-five and one hundred and thirty-six light 10 1/2, distance between one hundred and thirty-six and one hundred and thirty-seven light 45, distance between one hundred and thirty-seven and one hundred and thirty-eight light 29, distance between one hundred and thirty-eight and one hundred and thirty-nine light 10 1/2, distance between one hundred and thirty-nine and one hundred and forty light 45, distance between one hundred and forty and one hundred and forty-one light 29, distance between one hundred and forty-one and one hundred and forty-two light 10 1/2, distance between one hundred and forty-two and one hundred and forty-three light 45, distance between one hundred and forty-three and one hundred and forty-four light 29, distance between one hundred and forty-four and one hundred and forty-five light 10 1/2, distance between one hundred and forty-five and one hundred and forty-six light 45, distance between one hundred and forty-six and one hundred and forty-seven light 29, distance between one hundred and forty-seven and one hundred and forty-eight light 10 1/2, distance between one hundred and forty-eight and one hundred and forty-nine light 45, distance between one hundred and forty-nine and one hundred and fifty light 29, distance between one hundred and fifty and one hundred and fifty-one light 10 1/2, distance between one hundred and fifty-one and one hundred and fifty-two light 45, distance between one hundred and fifty-two and one hundred and fifty-three light 29, distance between one hundred and fifty-three and one hundred and fifty-four light 10 1/2, distance between one hundred and fifty-four and one hundred and fifty-five light 45, distance between one hundred and fifty-five and one hundred and fifty-six light 29, distance between one hundred and fifty-six and one hundred and fifty-seven light 10 1/2, distance between one hundred and fifty-seven and one hundred and fifty-eight light 45, distance between one hundred and fifty-eight and one hundred and fifty-nine light 29, distance between one hundred and fifty-nine and one hundred and sixty light 10 1/2, distance between one hundred and sixty and one hundred and sixty-one light 45, distance between one hundred and sixty-one and one hundred and sixty-two light 29, distance between one hundred and sixty-two and one hundred and sixty-three light 10 1/2, distance between one hundred and sixty-three and one hundred and sixty-four light 45, distance between one hundred and sixty-four and one hundred and sixty-five light 29, distance between one hundred and sixty-five and one hundred and sixty-six light 10 1/2, distance between one hundred and sixty-six and one hundred and sixty-seven light 45, distance between one hundred and sixty-seven and one hundred and sixty-eight light 29, distance between one hundred and sixty-eight and one hundred and sixty-nine light 10 1/2, distance between one hundred and sixty-nine and one hundred and seventy light 45, distance between one hundred and seventy and one hundred and seventy-one light 29, distance between one hundred and seventy-one and one hundred and seventy-two light 10 1/2, distance between one hundred and seventy-two and one hundred and seventy-three light 45, distance between one hundred and seventy-three and one hundred and seventy-four light 29, distance between one hundred and seventy-four and one hundred and seventy-five light 10 1/2, distance between one hundred and seventy-five and one hundred and seventy-six light 45, distance between one hundred and seventy-six and one hundred and seventy-seven light 29, distance between one hundred and seventy-seven and one hundred and seventy-eight light 10 1/2, distance between one hundred and seventy-eight and one hundred and seventy-nine light 45, distance between one hundred and seventy-nine and one hundred and eighty light 29, distance between one hundred and eighty and one hundred and eighty-one light 10 1/2, distance between one hundred and eighty-one and one hundred and eighty-two light 45, distance between one hundred and eighty-two and one hundred and eighty-three light 29, distance between one hundred and eighty-three and one hundred and eighty-four light 10 1/2, distance between one hundred and eighty-four and one hundred and eighty-five light 45, distance between one hundred and eighty-five and one hundred and eighty-six light 29, distance between one hundred and eighty-six and one hundred and eighty-seven light 10 1/2, distance between one hundred and eighty-seven and one hundred and eighty-eight light 45, distance between one hundred and eighty-eight and one hundred and eighty-nine light 29, distance between one hundred and eighty-nine and one hundred and ninety light 10 1/2, distance between one hundred and ninety and one hundred and ninety-one light 45, distance between one hundred and ninety-one and one hundred and ninety-two light 29, distance between one hundred and ninety-two and one hundred and ninety-three light 10 1/2, distance between one hundred and ninety-three and one hundred and ninety-four light 45, distance between one hundred and ninety-four and one hundred and ninety-five light 29, distance between one hundred and ninety-five and one hundred and ninety-six light 10 1/2, distance between one hundred and ninety-six and one hundred and ninety-seven light 45, distance between one hundred and ninety-seven and one hundred and ninety-eight light 29, distance between one hundred and ninety-eight and one hundred and ninety-nine light 10 1/2, distance between one hundred and ninety-nine and two hundred light 45, distance between two hundred and two hundred and one light 29, distance between two hundred and one and two hundred and two light 10 1/2, distance between two hundred and two and two hundred and three light 45, distance between two hundred and three and two hundred and four light 29, distance between two hundred and four and two hundred and five light 10 1/2, distance between two hundred and five and two hundred and six light 45, distance between two hundred and six and two hundred and seven light 29, distance between two hundred and seven and two hundred and eight light 10 1/2, distance between two hundred and eight and two hundred and nine light 45, distance between two hundred and nine and two hundred and ten light 29, distance between two hundred and ten and two hundred and eleven light 10 1/2, distance between two hundred and eleven and two hundred and twelve light 45, distance between two hundred and twelve and two hundred and thirteen light 29, distance between two hundred and thirteen and two hundred and fourteen light 10 1/2, distance between two hundred and fourteen and two hundred and fifteen light 45, distance between two hundred and fifteen and two hundred and sixteen light 29, distance between two hundred and sixteen and two hundred and seventeen light 10 1/2, distance between two hundred and seventeen and two hundred and eighteen light 45, distance between two hundred and eighteen and two hundred and nineteen light 29, distance between two hundred and nineteen and two hundred and twenty light 10 1/2, distance between two hundred and twenty and two hundred and twenty-one light 45, distance between two hundred and twenty-one and two hundred and twenty-two light 29, distance between two hundred and twenty-two and two hundred and twenty-three light 10 1/2, distance between two hundred and twenty-three and two hundred and twenty-four light 45, distance between two hundred and twenty-four and two hundred and twenty-five light 29, distance

DESCRIPTION:				FRONT & REAR EXTERIOR	
SCALE:				5/16"=1'	
REVISION:				F	
Note: Drawings are for reference only, measurements may vary from actual product.					

SCALE: 5/16"=1'
REVISION: F

Note: Drawings are for reference only, measurements may vary from actual product

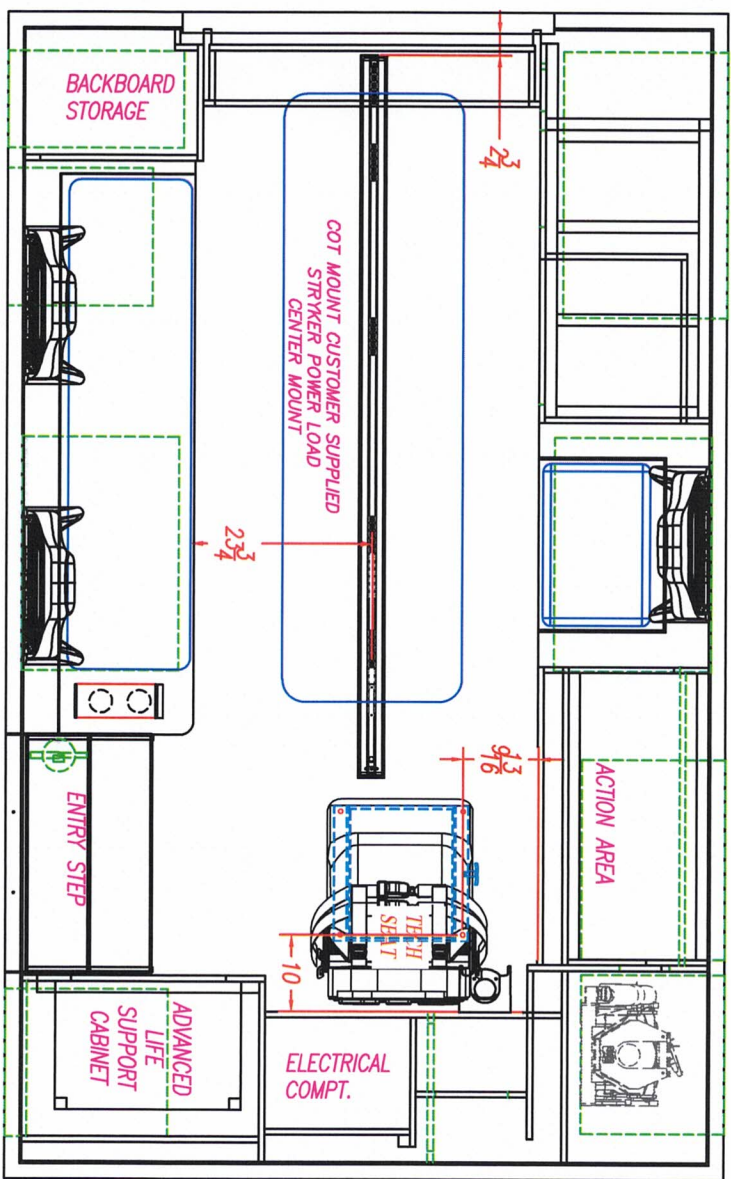

FORD F-450 169" W.B.
ME-153"-72" H.R. TYPE I AMBULANCE

PATIENT AREA PLAN

SCALE:	1/2"=1'
REVISION:	F

Note: Drawings are for reference only, measurements may vary from actual product.

NOTE: CORIAN COUNTERTOPS IN 1ST & 2ND AA

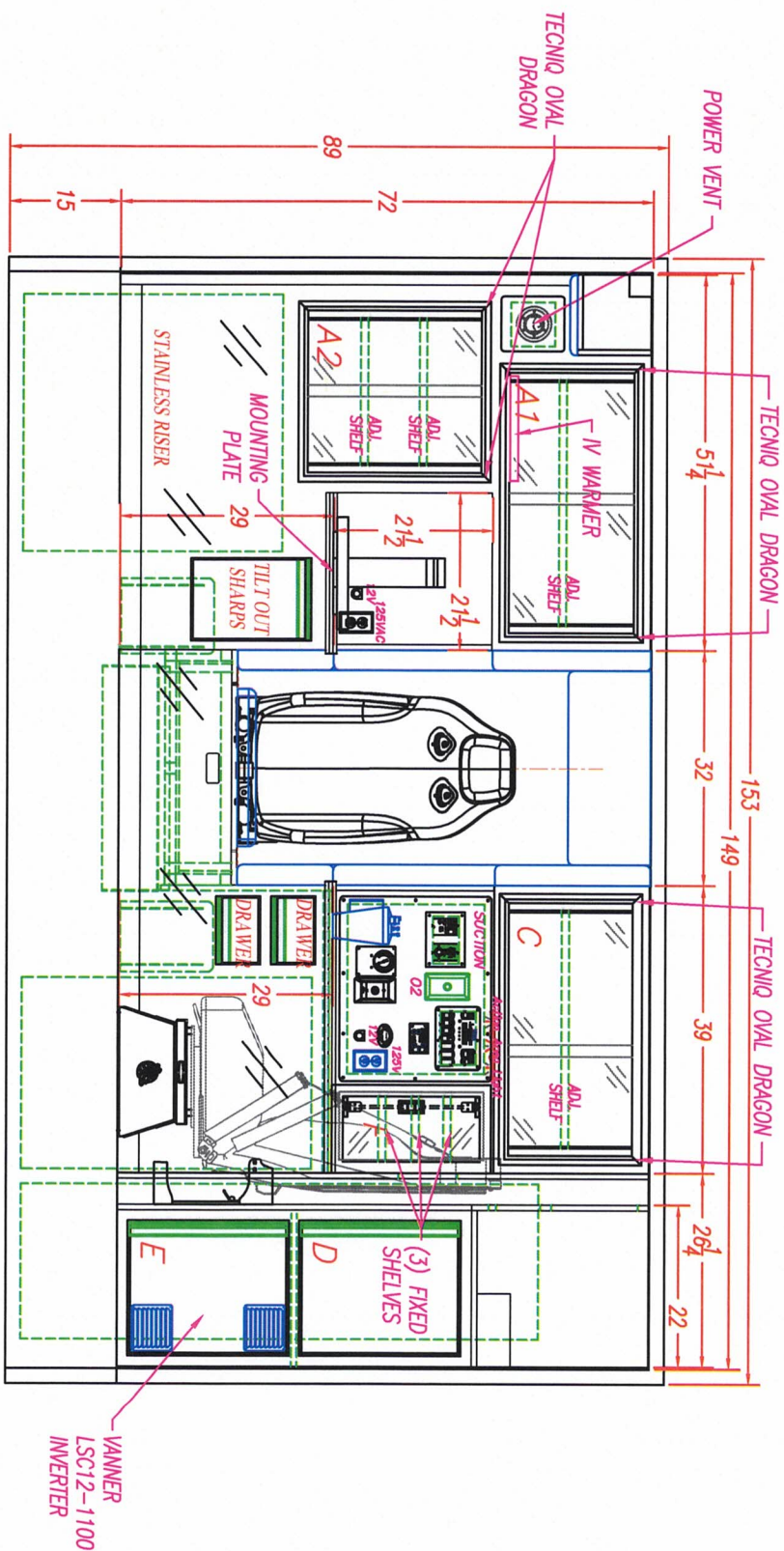

INTERIOR CABINET STORAGE

ITEM	HEIGHT	WIDTH	DEPTH	SPECIAL NOTE
A1	17 3/4"	36 1/4"	18"	
A2	24 3/4"	23"	18"	
C	16 3/4"	35 1/4"	15"	
D	23 1/4"	21"	17 1/4"	
E	23 1/4"	21"	17 1/4"	
F	18 1/2"	9"	4 3/4"	

Note: Drawings are for reference only, measurements may vary from actual product.

Note: Drawings are for reference only, measurements may vary from actual product.

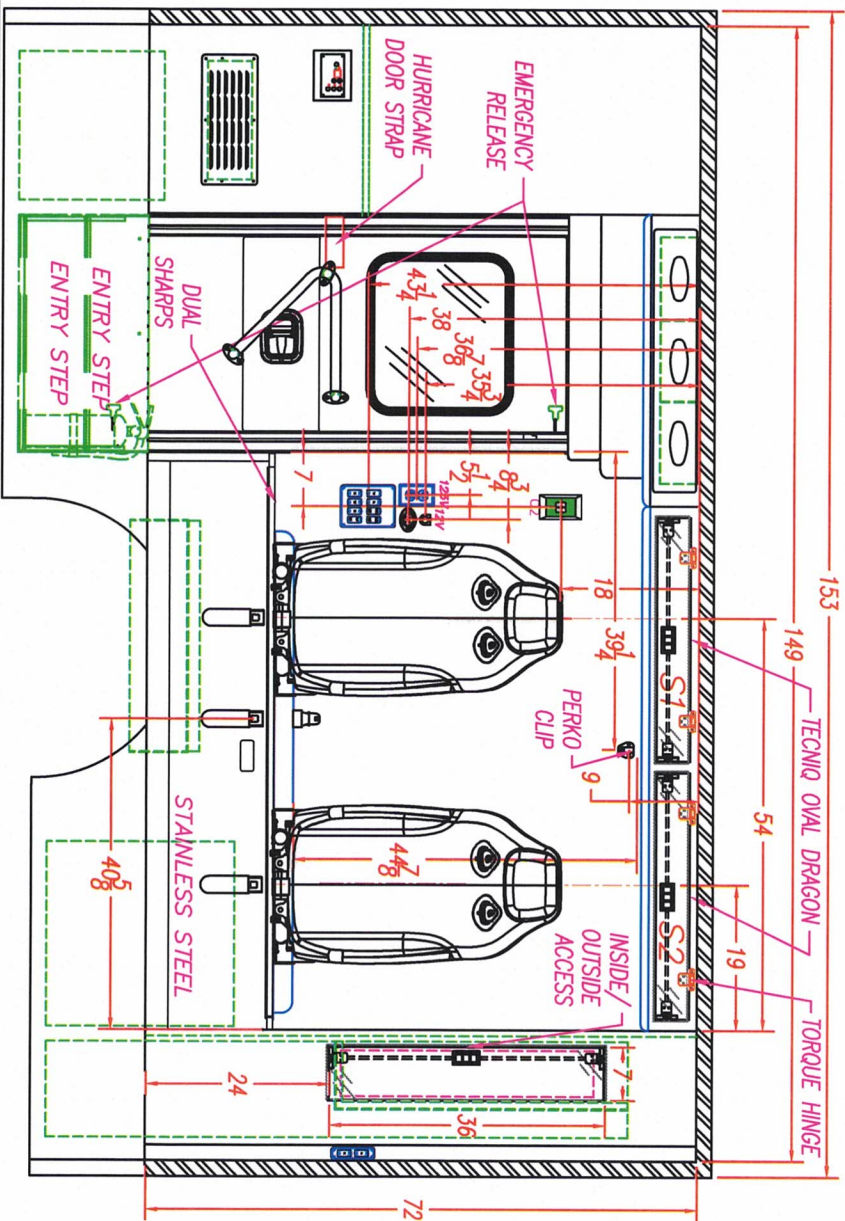

4" SEATBELT PLATE LOCATION

WELD SHOP	33	INCHES	NOTE: THIS DIMENSION IS FROM THE BOTTOM OF THE WALL TO THE BOTTOM OF THE 4" PLATE.			
CABINET SHOP	NOTE: THE HOLES FOR THE TOP SEATBELT BOLTS ARE 1 1/2" FROM THE TOP OF THE SQUAD BENCH TO THE CENTER OF THE SEATBELT BOLT. NOTE: THE HOLES FOR THE BOTTOM SEATBELT BOLTS ON THE SQUAD BENCH ARE 9 3/4" FROM THE TOP OF THE FLOOR TO THE CENTER OF THE BOLT.					
NOTE: READ THE DIMENSIONS FROM RIGHT TO LEFT AS VIEWED	THE LOCATION OF THE BOTTOM SEATBELT HOLES ARE FROM THE REAR OF THE SQUAD BENCH TO THE CENTER OF THE 1/2" HOLE		BOTTOM	54"		
	THE LOCATION OF THE TOP SEATBELT HOLES ARE FROM THE REAR WALL TO THE CENTER OF THE 1/2" HOLE		TOP	54"		
					40 5/8"	19"
					40 3/8"	19"

FORD F-450 169" W.B.
ME-153"-72" H.R. TYPE I AMBULANCE
CURB SIDE INTERIOR

SCALE:
1 1/2"=1'
REVISION:
F

Note: Drawings are for reference only, measurements may vary from actual product.

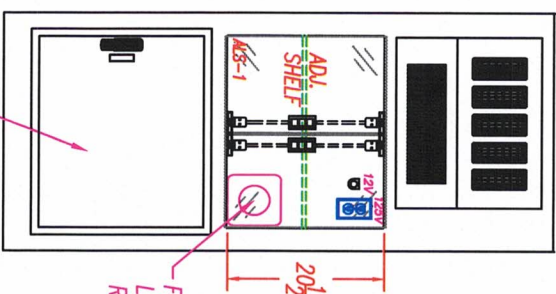
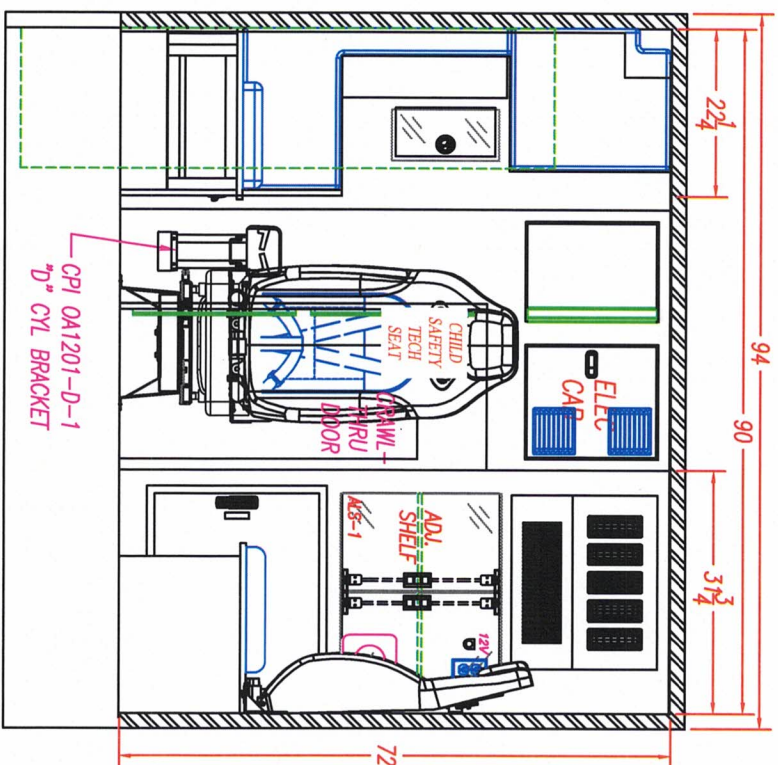

INTERIOR CABINET STORAGE

ITEM	HEIGHT	WIDTH	DEPTH	SPECIAL NOTE
MS-1	20 1/2"	25 1/2"	20 1/2"	

FORD F-450 169" W.B.
ME-153"-72" H.R. TYPE I AMBULANCE
DESCRIPTION:

FRONT ELEVATION

SCALE:
1/2"=1'
REVISION:
F

Note: Drawings are for reference only, measurements may vary from actual product.

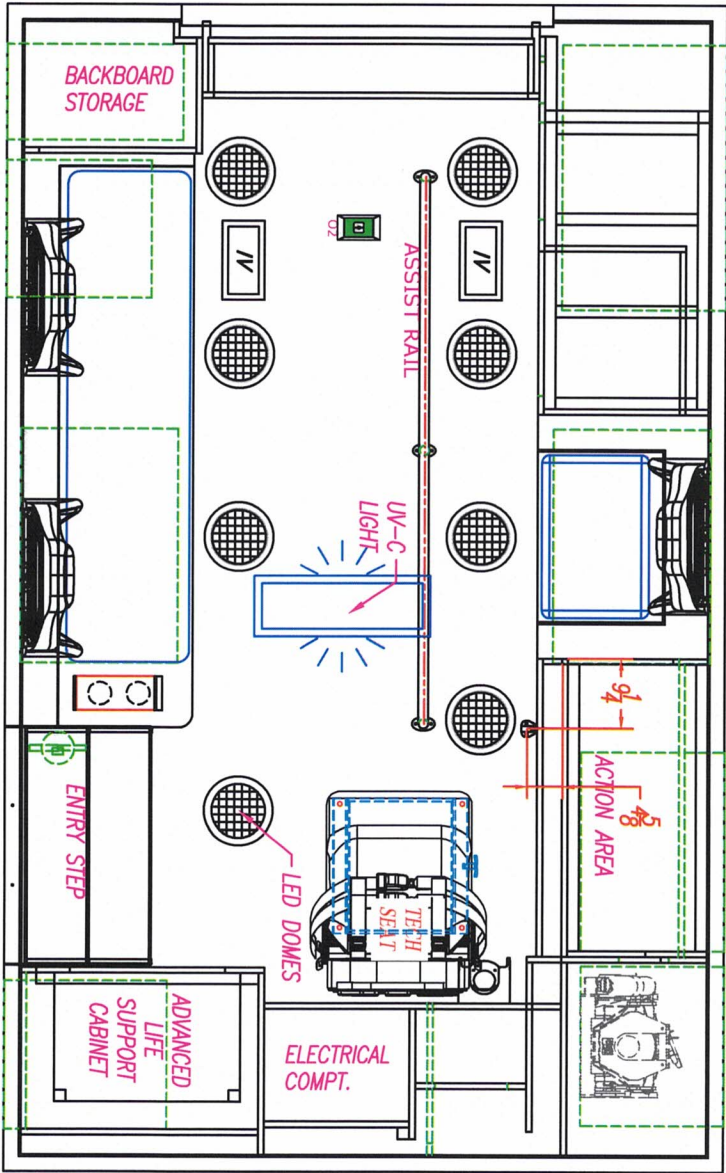

FORD F-450 169" W.B.

ME-153"-72" H.R. TYPE I AMBULANCE

CEILING LAYOUT

SCALE:
1/2"=1'
REVISION:
F

Note: Drawings are for reference only, measurements may vary from actual product.

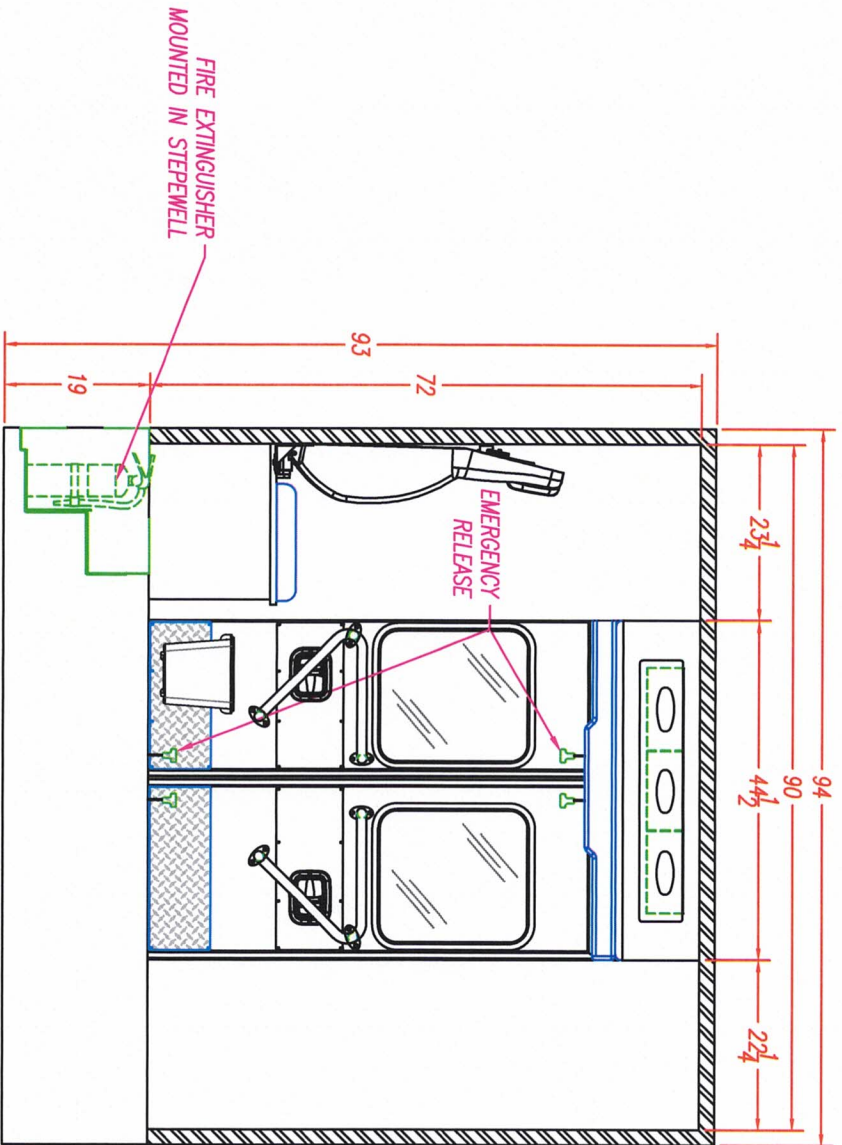

INTERIOR CABINET STORAGE

ITEM	HEIGHT	WIDTH	DEPTH	SPECIAL NOTE
A	6 1/2"	40 3/4"	7"	

FORD F-450 169" W.B.
ME-153"-72" H.R. TYPE I AMBULANCE

REAR ELEVATION

SCALE:
1/2"=1'
REVISION:
F

Note: Drawings are for reference only, measurements may vary from actual product.

NAVAJO NATION CERTIFICATION
Regarding Debarment, Suspension, and
Contracting Eligibility

1. Applicant entity acknowledges that to the best of its knowledge that the Applicant entity, either in its present form or in any identifiable capacity, has not, in accordance with 12 N.N.C. § 361:
 - A. Been convicted of the commission of criminal offenses incident to obtaining or attempting to obtain a public or private contract or subcontract, or in the performance of any such contract or subcontract;
 - B. Been convicted of embezzlement, theft, forgery, bribery, falsification or destruction of records, receiving stolen property, or other offenses indicating a lack of business integrity or honesty, which currently, seriously, and directly affect responsibility as a Navajo Nation contractor;
 - C. Been convicted under antitrust statutes arising out of the submission of bids or proposals;
 - D. Violated contract provisions, including:
 - i. Deliberate failure, without good cause, to perform in accordance with the contract specifications or within the time limit provided in the contract,
 - ii. A recent record of failure to perform or of unsatisfactory performance with the terms of any contract, or
 - iii. Any other cause so serious and compelling as to affect responsibility as a Navajo Nation contractor, including debarment by another governmental entity.
2. Applicant acknowledges that if the Navajo Nation determines that the executed Certification provided herein is untrue or not wholly accurate, it shall be grounds for the Navajo Nation to terminate the contract and pursue other legal remedies, at the Navajo Nation's discretion.
3. Applicant certifies to the best of its knowledge that it is eligible to do business with the

Navajo Nation, in its present form or in any other identifiable capacity, pursuant to 12 N.N.C. § 1501 and 5 N.N.C. § 301. Applicant also acknowledges that per 12 N.N.C. § 1505, it will not be eligible to contract with the Navajo Nation if deemed ineligible by the appropriate department or entity of the Navajo Nation which receives the Applicant's request for consideration for a business opportunity.

Applicant Name

Name of individual signing on Applicant's behalf (print)

Applicant Address

Title of individual signing on Applicant's behalf

Applicant Address

Signature of individual signing on Applicant's behalf

Applicant Address

Date

**Request for Taxpayer
Identification Number and Certification**

Go to www.irs.gov/FormW9 for instructions and the latest information.

**Give form to the
requester. Do not
send to the IRS.**

Before you begin. For guidance related to the purpose of Form W-9, see *Purpose of Form*, below.

Print or type. See Specific Instructions on page 3.	1 Name of entity/individual. An entry is required. (For a sole proprietor or disregarded entity, enter the owner's name on line 1, and enter the business/disregarded entity's name on line 2.)	
	2 Business name/disregarded entity name, if different from above.	
	3a Check the appropriate box for federal tax classification of the entity/individual whose name is entered on line 1. Check only one of the following seven boxes. <input type="checkbox"/> Individual/sole proprietor <input type="checkbox"/> C corporation <input type="checkbox"/> S corporation <input type="checkbox"/> Partnership <input type="checkbox"/> Trust/estate <input type="checkbox"/> LLC. Enter the tax classification (C = C corporation, S = S corporation, P = Partnership) Note: Check the "LLC" box above and, in the entry space, enter the appropriate code (C, S, or P) for the tax classification of the LLC, unless it is a disregarded entity. A disregarded entity should instead check the appropriate box for the tax classification of its owner. <input type="checkbox"/> Other (see instructions) _____	4 Exemptions (codes apply only to certain entities, not individuals; see instructions on page 3): Exempt payee code (if any) _____ Exemption from Foreign Account Tax Compliance Act (FATCA) reporting code (if any) _____ (Applies to accounts maintained outside the United States.)
	3b If on line 3a you checked "Partnership" or "Trust/estate," or checked "LLC" and entered "P" as its tax classification, and you are providing this form to a partnership, trust, or estate in which you have an ownership interest, check this box if you have any foreign partners, owners, or beneficiaries. See instructions <input type="checkbox"/>	
	5 Address (number, street, and apt. or suite no.). See instructions.	Requester's name and address (optional)
6 City, state, and ZIP code		
7 List account number(s) here (optional)		

Part I Taxpayer Identification Number (TIN)

Enter your TIN in the appropriate box. The TIN provided must match the name given on line 1 to avoid backup withholding. For individuals, this is generally your social security number (SSN). However, for a resident alien, sole proprietor, or disregarded entity, see the instructions for Part I, later. For other entities, it is your employer identification number (EIN). If you do not have a number, see *How to get a TIN*, later.

Note: If the account is in more than one name, see the instructions for line 1. See also *What Name and Number To Give the Requester* for guidelines on whose number to enter.

Social security number											
				-				-			
or											
Employer identification number											
					-						

Part II Certification

Under penalties of perjury, I certify that:

1. The number shown on this form is my correct taxpayer identification number (or I am waiting for a number to be issued to me); and
2. I am not subject to backup withholding because (a) I am exempt from backup withholding, or (b) I have not been notified by the Internal Revenue Service (IRS) that I am subject to backup withholding as a result of a failure to report all interest or dividends, or (c) the IRS has notified me that I am no longer subject to backup withholding; and
3. I am a U.S. citizen or other U.S. person (defined below); and
4. The FATCA code(s) entered on this form (if any) indicating that I am exempt from FATCA reporting is correct.

Certification instructions. You must cross out item 2 above if you have been notified by the IRS that you are currently subject to backup withholding because you have failed to report all interest and dividends on your tax return. For real estate transactions, item 2 does not apply. For mortgage interest paid, acquisition or abandonment of secured property, cancellation of debt, contributions to an individual retirement arrangement (IRA), and, generally, payments other than interest and dividends, you are not required to sign the certification, but you must provide your correct TIN. See the instructions for Part II, later.

Sign Here	Signature of U.S. person	Date

General Instructions

Section references are to the Internal Revenue Code unless otherwise noted.

Future developments. For the latest information about developments related to Form W-9 and its instructions, such as legislation enacted after they were published, go to www.irs.gov/FormW9.

What's New

Line 3a has been modified to clarify how a disregarded entity completes this line. An LLC that is a disregarded entity should check the appropriate box for the tax classification of its owner. Otherwise, it should check the "LLC" box and enter its appropriate tax classification.

New line 3b has been added to this form. A flow-through entity is required to complete this line to indicate that it has direct or indirect foreign partners, owners, or beneficiaries when it provides the Form W-9 to another flow-through entity in which it has an ownership interest. This change is intended to provide a flow-through entity with information regarding the status of its indirect foreign partners, owners, or beneficiaries, so that it can satisfy any applicable reporting requirements. For example, a partnership that has any indirect foreign partners may be required to complete Schedules K-2 and K-3. See the Partnership Instructions for Schedules K-2 and K-3 (Form 1065).

Purpose of Form

An individual or entity (Form W-9 requester) who is required to file an information return with the IRS is giving you this form because they

FORM 1 (ADMINISTRATIVE PURPOSES ONLY)

**SERVICES CONTRACT BETWEEN
THE NAVAJO NATION
AND**

Consultant's Legal Name (this must match the name on the Contractor's W-9 and Certificate of Insurance)

Consultant's physical address, state and zip code

Consultant's telephone number

CONTRACT NO: _____

FOR THE PERIOD: BEGINNING _____
ENDING _____

PAYMENTS TO BE MADE FROM:

Account: _____ - _____ Fees: \$ _____

Account: _____ - _____ Expenses: \$ _____

Account: _____ - _____ Taxes: \$ _____

TOTAL PAYMENTS ON THIS CONTRACT NOT TO EXCEED: \$ _____

UNDER THE TERMS AND CONDITIONS OUTLINED IN:

ATTACHMENT A – Mutual Promises and Agreements

ATTACHMENT B – Scope of Work

EXHIBITS:

EXHIBIT A – Accounting Codes and Budget

EXHIBIT B – Consultant Credentials

EXHIBIT C – Certificate of Insurance

EXHIBIT D – _____

EXHIBIT E – _____

Employer's Identification No.: _____

Or *this number must match Form W-9*

Consultant's Social Security No.: _____

SERVICES CONTRACT

ATTACHMENT A – Mutual Promises and Agreements

This Services Contract (“Contract”) is made and entered into by and between the Navajo Nation, hereinafter called the “**NATION**” and _____, hereinafter called the “**CONSULTANT**.” Collectively, the **NATION** and the **CONSULTANT** are the “**PARTIES**.” The **PARTIES** agree as follows:

1. **Contract Term.** The **NATION** agrees to use the non-exclusive services of the **CONSULTANT** beginning _____, and ending _____.
2. **Documents Constituting the Contract.** The following are to be considered collectively as one agreement/contract and the term Contract whenever used herein shall be deemed to include all such documents:
 - this ATTACHMENT A – Mutual Promises and Agreements;
 - ATTACHMENT B – Scope of Work (“Scope of Work”);
 - EXHIBIT A – Accounting Codes and Budget;
 - EXHIBIT B – Consultant Credentials;
 - EXHIBIT C – Certificate of Insurance; and (where applicable)
 - EXHIBIT D – _____; and
 - EXHIBIT E – _____.
3. **Scope of Work.** The **CONSULTANT** agrees to perform the services described in **ATTACHMENT B – Scope of Work**. Any changes to the Scope of Work must be agreed to by the **PARTIES** through a formal Modification of the Contract pursuant to Paragraph 13 below.
4. **Compensation.** The **NATION** agrees to compensate the **CONSULTANT** for services performed under this Contract by paying a sum not to exceed \$ _____, as per **EXHIBIT A – Accounting Codes and Budget**, to include the Navajo Nation and local government sales tax amounts described in Paragraph 18 below, for work performed within the territorial jurisdiction of the **NATION**.
5. **Authorized Representative.** The **CONSULTANT** shall work with the _____ (*Contracting Program*), and its Authorized Representative, _____, in the performance of work or services under this Contract. No payment shall be made unless said Authorized Representative approves the work performed or services provided under this Contract and has approved the invoice(s) submitted by the **CONSULTANT**. Only the Authorized Representative or someone formally delegated by the Authorized Representative may assign tasks under the Scope of Work. All invoiced expenditures must be supported by receipts.
6. **Contract Number.** Contract Number C- _____ shall cover this Contract, and reference to this number shall be made on all invoices submitted by the **CONSULTANT** to the **NATION** for payment.
7. **Availability of Funds.** The liability of the **NATION** under this Contract is contingent upon the availability of funds. Pursuant to 2 N.N.C. § 223(B), all contracts shall have sufficient funds available to perform the services under the Contract.
8. **Travel Expenses.** The **PARTIES** recognize that the **CONSULTANT** may incur reasonable travel expenses in connection with providing services to the **NATION**. For said travel expenses to be eligible for reimbursement hereunder, the Authorized Representative must approve the travel in writing before said expenses are incurred.
9. **Consultant is an Independent Contractor.** Neither **CONSULTANT** nor its employees are, or shall be deemed, **NATION** employees. In its capacity as an independent contractor, **CONSULTANT** agrees and

represents, and the **NATION** agrees, that **CONSULTANT**: (a) has the sole right to control and direct the means, manner, and method by which the services will be performed; (b) shall utilize its own employees, facilities, equipment, tools, and supplies in performing the services; (c) is not eligible to participate in, and is not eligible for coverage under any **NATION** employee benefit plans or offerings; and (d) is free to make its services available to third parties. Nothing in this Contract shall be construed to create any agency or employment relationship between **CONSULTANT** or any of its employees and the **NATION**. Neither Party shall have any right, power, or authority to assume, create, or incur any expense, liability, or obligation, express or implied, on behalf of the other. The **CONSULTANT** is responsible for payment of all taxes related to this Contract, and except as otherwise provided in Section 18 below, the **NATION** is not responsible for withholding, and shall not withhold, income taxes, FICA, unemployment taxes, or other taxes of any kind from any payment it owes to **CONSULTANT**, nor shall the **NATION** be responsible for remitting the employer's share of employment taxes to federal or state governments.

10. **The Nation's Ownership of Work Product.** The product(s) and title of the **CONSULTANT'S** work and services under this Contract shall be and will remain the property of the **NATION**. The **NATION** may use the work product for any purpose without prior approval or additional payment.
11. **The Nation's Right to Inspect Place of Business and to Inspect and Audit Books and Records.** The **CONSULTANT** agrees that the **NATION** may, at reasonable times, inspect the part of the plant or place of business of the **CONSULTANT** that is related to the performance of this Contract; and **CONSULTANT** further agrees that the **NATION** may, at reasonable times and places, inspect and audit the **CONSULTANT'S** books and records to the extent that such books and records relate to the performance of this Contract. The **CONSULTANT** shall maintain such books and records, and such books and records of any Subcontractor, for at least five (5) years from the date of final payment under this Contract. Further, **CONSULTANT** agrees to include in any Subcontractor agreement related to this Contract, provisions that the Subcontractor agrees (a) that the **NATION** may, at reasonable times, inspect the part of the plant or place of business of the Subcontractor that is related to the performance of this Contract; (b) that the **NATION** may, at reasonable times and places, inspect and audit the Subcontractor's books and records to the extent that such books and records relate to the performance of this Contract; and (c) that the Subcontractor shall maintain its books and records related to the performance of this Contract for at least five (5) years from the date of the **CONSULTANT'S** final payment under this Contract.
12. **Contact Information; Final Invoice.** Copies of all correspondence, reports, and invoices under this Contract shall be furnished to:

*Insert the **NATION'S** and the **CONSULTANT'S** contact and contact information:*

_____	_____
_____	_____
_____	_____
_____	_____
_____	_____

NOTE: The final invoice will be due within thirty (30) days after the Contract ends.

13. **Indemnification.** The **CONSULTANT** agrees to hold harmless and indemnify the **NATION** against any and all losses, costs, damages, claims, accident or injury to person or property including death, attorneys' fees, expenses, and other liability whatsoever (collectively, "Claims"), arising under, related to, or in connection with this Contract, except to the extent such Claims are directly caused by the gross negligence or wanton and willful

conduct of the **NATION** or to the extent they result from the negligence of **NATION** officials or employees as provided for and in accordance with 1 N.N.C. § 551 *et seq.*

14. **Modifications.** Any modifications to this Contract shall be made only by written amendment, signed and executed by all parties to this Contract. If a cost-based selection method, such as the submission and evaluation of bids, was used to procure this Contract, any amendment to increase this Contract that exceeds twenty percent (20%) of the original accepted bid amount shall be handled pursuant to 2 N.N.C. § 223(F).
15. **Disputes; No Waiver of Sovereign Immunity.** Any and all disputes arising under, related to, or in connection with this Contract will be resolved first through negotiation between the **PARTIES** under the laws of the **NATION**. If negotiation does not resolve the dispute, the **NATION** may pursue legal action. Nothing herein shall be construed as a waiver of the **NATION'S** sovereign immunity.
16. **Termination.** The **NATION** may terminate this Contract at any time upon ten (10) days advance written notice to the **CONSULTANT**, in the event that: (a) the **NATION**, in its sole discretion, determines the **CONSULTANT'S** work or services provided are not satisfactory; (b) the **CONSULTANT** fails to submit reports and other documents as requested by the **NATION** within defined time schedules to the satisfaction of the **NATION**; (c) the **CONSULTANT** fails to submit verification of invoices to the **NATION** for payment to the satisfaction of the **NATION**; (d) the **CONSULTANT** is in breach of any material term or condition of this Contract; or (e) funds are not appropriated or otherwise made available to support continuation of this Contract.
17. **Applicable Law and Jurisdiction.** The **CONSULTANT** shall comply with all Navajo Nation laws, as they may be amended from time to time, including, but not limited to, the Navajo Business and Procurement Act, 12 N.N.C. § 1501 *et seq.*, the Navajo Preference in Employment Act, 15 N.N.C. § 601 *et seq.*, the Navajo Nation Business Opportunity Act, 5 N.N.C. § 201 *et seq.*, the Navajo Nation Corporation Act, 5 N.N.C. § 3101 *et seq.*, the Navajo Nation Limited Liability Company Act, 5 N.N.C. § 3600 *et seq.*, the Navajo Uniform Commercial Code, 5A N.N.C. § 1-101 *et seq.*, and applicable regulations. The **CONSULTANT** agrees to be subject to the jurisdiction of Navajo Nation courts and tribunals.
18. **Pre-Contract Costs.** Costs incurred before the finalization of this Contract deemed reasonable, allowable, and allocable to performance of the Contract as agreed to by the **PARTIES** may be paid under this Contract.
19. **Navajo Nation Taxes.** The **CONSULTANT** shall comply with all applicable Navajo Nation tax laws under Title 24 of the Navajo Nation Code and corresponding regulations. The **CONSULTANT** is subject to and shall be liable for payment of the Navajo Nation Sales Tax, at the prevailing rate, on gross receipts for all work performed within the territorial jurisdiction of the Navajo Nation pursuant to 24 N.N.C. § 601 *et seq.*, and the Navajo Nation Sales Tax Regulations § 6.101 *et seq.*, as amended from time to time, except that work performed within the To'Nanees'Dizi Local Government ("Tuba City Chapter") or the Kayenta Township is subject to their respective local sales taxes as amended from time to time. In addition to being subject to Navajo Nation Sales Tax, the **CONSULTANT** is subject to local sales tax on gross receipts for all work performed within a governance-certified chapter that imposes a local sales tax pursuant to a duly enacted local tax ordinance and the Uniform Local Tax Code, 24 N.N.C. §150 *et seq.*

The **CONSULTANT** shall segregate, on each invoice, the work performed within and outside the territorial jurisdiction of the Navajo Nation, and within and outside the jurisdictions of governance-certified chapters that impose a local sales tax. The **NATION** shall withhold from each payment to the **CONSULTANT** the applicable Navajo Nation Sales Tax and/or local sales tax due from the total invoice amount associated with work performed within the Navajo Nation and/or within governance-certified chapters that impose a local sales tax (excluding Tuba City Chapter and Kayenta Township). The amount withheld reflects the Navajo Nation Sales Tax and/or local sales tax due on such invoice amounts. The **NATION** shall transfer the withheld amount to the Office of the Navajo Tax Commission as payment of the Navajo Nation Sales Tax and/or local sales tax on behalf of the **CONSULTANT**. The **CONSULTANT** will then indicate on the quarterly tax return or returns

required for the Navajo Nation Sales Tax and/or local sales tax that this amount has been previously withheld and paid to the Office of the Navajo Tax Commission. It is hereby acknowledged that the **NATION** withholding amounts pursuant to this section in no way removes responsibility from the **CONSULTANT** as a taxpayer for timely filing of tax returns and timely payment of any other amounts, which may be owed for taxes.

The **CONSULTANT** is subject to the Tuba City Chapter Sales Tax on gross receipts for all work performed within the Tuba City Chapter pursuant to the To’Nanees’Dizi Local Government Tax Code, as may be amended from time to time, and shall pay the sales tax directly to the Tuba City Chapter. The **CONSULTANT** is subject to the Kayenta Township Sales Tax on gross receipts for all work performed within the Kayenta Township pursuant to the Kayenta Township Tax Ordinances, as may be amended from time to time, and shall pay the sales tax directly to the Kayenta Township. The **NATION** shall not withhold this portion of the tax that is directly payable to Tuba City Chapter or Kayenta Township.

The **CONSULTANT** is solely responsible for the payment of all applicable taxes.

20. **Consultant Debarment; Suspension.** If the **CONSULTANT** in its present form or any other identifiable capacity as an individual, business corporation, partnership or other entity is deemed ineligible, debarred, or suspended pursuant to the Navajo Business and Procurement Act, 12 N.N.C. § 1501 *et seq.* or the Navajo Nation Procurement Act, 12 N.N.C. § 301 *et seq.*, the **CONSULTANT** is not legally able to enter into this Contract, and this Contract shall be null and void unless the factors that warranted the ineligibility, debarment or suspension have been sufficiently addressed as provided by applicable Navajo Nation laws.
21. **Insurance Coverage.** The **CONSULTANT** shall obtain and maintain adequate insurance coverage as recommended and verified by the Navajo Nation Risk Management Program (“RMP”) for the entire term of the Contract. The insurance coverage shall name the **NATION** as an additional insured as specified by the RMP, and the **CONSULTANT** shall notify the contracting program and the RMP, c/o The Navajo Nation, P.O. Box 1690, Window Rock, Arizona 86515, within five (5) days of any change in the insurance policy. Proof of such insurance is attached as **Exhibit C – Certificate of Insurance**. The failure to fully comply with this provision shall render this Contract null and void.
22. **Conflicting and Additional Terms.** Any additional terms and conditions of the **CONSULTANT** are attached hereto and incorporated into this Contract, provided however that in the event of any conflict between the terms and conditions of this Contract and any of the **CONSULTANT’S** additional terms and conditions, the terms and conditions of this Contract shall control and govern. Any additional terms and conditions not attached to this Contract shall have no force or effect.

SIGNATURES OF THE CONTRACT

For the Consultant:

For the Navajo Nation:

Date

Branch Chief

Date

The Navajo Nation

Post Office Box 9000

Window Rock, Arizona 86515

SERVICES CONTRACT

ATTACHMENT B – Scope of Work (include timeframe)

FIRM NAME _____

ADDRESS _____

TELEPHONE NO. _____

SERVICES CONTRACT

EXHIBIT A – Accounting Codes and Budget

FIRM NAME _____
ADDRESS _____
TELEPHONE NO. _____

ACCOUNTING CODES

<u>Account Number</u>	<u>Account Name</u>	<u>Item Totals</u>
_____ - _____	_____	\$ _____
_____ - _____	_____	\$ _____
_____ - _____	_____	\$ _____

TOTAL CONSULTANT FEES AND EXPENSES: \$ _____

ATTACH A DETAILED BUDGET TO THIS EXHIBIT

The detailed budget total must match the totals above and the totals on Page 1 of the Contract.

Consider using the SAMPLE FORMULAS below:

_____ – **Cost Estimate – Fees**

\$ _____ per day or per hour x _____ work days or work hours outside the Navajo Nation: \$ _____
\$ _____ per day or per hour x _____ work days or work hours within the Navajo Nation: \$ _____
_____ Percent Navajo Nation tax on fees for work within the Navajo Nation: \$ _____
Total Fees: \$ _____

_____ – **Cost Estimate – Fees**

Travel (_____ miles x \$ _____ per mile): \$ _____
Meals (_____ meals x \$ _____ per meal): \$ _____
Lodging (\$ _____ per night x _____ required overnight stays): \$ _____
Airfare (\$ _____ per trip x _____ trips): \$ _____
Materials, supplies, and goods (list each item and associated cost): \$ _____
Total Expenses: \$ _____

SERVICES CONTRACT
EXHIBIT B - Consultant Credentials

FIRM NAME _____

ADDRESS _____

TELEPHONE NO. _____

FOR INTERNAL GUIDANCE ONLY - Include in this section:

1. Consultant's current resume. If Consultant is a firm, use the resume of the primary responsible party,
2. Signed Navajo Nation Certification Regarding Debarment and Suspension,
3. Completed and signed W-9 Form, and
4. Any other credentials that are relevant to the work in this contract.

SERVICES CONTRACT

EXHIBIT C - Certificate of Insurance

FIRM NAME _____
ADDRESS _____
TELEPHONE NO. _____

FOR INTERNAL GUIDANCE ONLY - Include in this section:

1. The Consultant's Certificate(s) of Insurance, and
2. The Risk Management Program's (RMP) signed memorandum indicating that the attached Certificate of Insurance meets RMP's minimum insurance requirements.